

Sleipner thrusters can be installed at an angle off the vertical centre.
Tailored to fit any space available in your vessel.

Weight 73kg / 160lbs

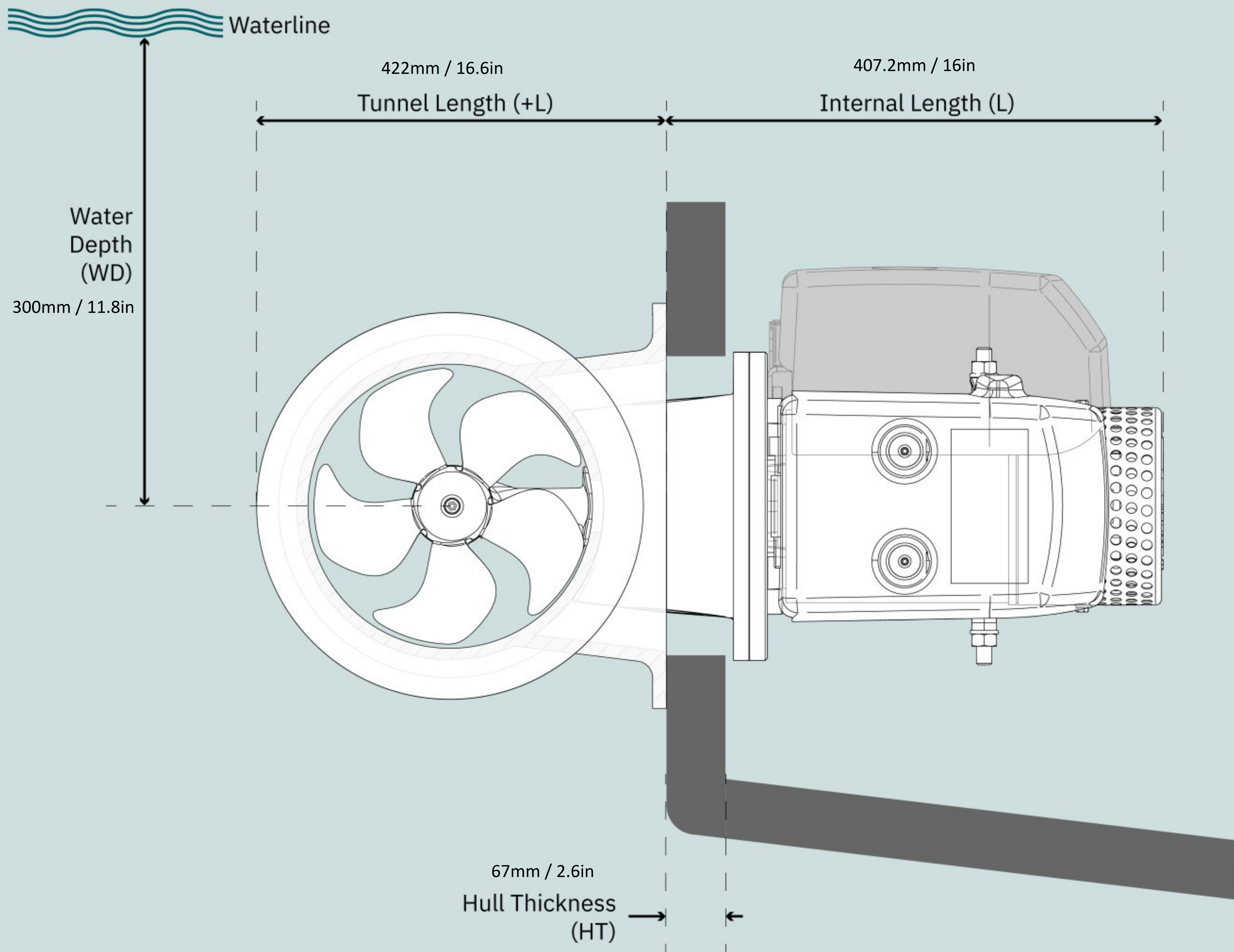

Power	Value
Operating Power	Electric
Power Requirement	48V DC
Power Output	15kW / 20hp
Thrust at 48V	340kg / 749lbs
Thrust at 42V	300kg / 661lbs
Operational Running Limit (min)	2-3 duty cycle at 20°C
Nominal Current Draw	400-450A
Min. Battery CCA (DIN)	400
Min. Battery CCA (SAE)	760
Min. Battery CCA (EN)	680
Recommended fuse	ANL 325

Operational Intention	Value
Ideal Vessel Class	Motor boat, Sail boat
Ideal Vessel Size	22-30m / 72-100ft
Bow Capability	Yes
Stern Capability	Yes
Retractable Capability	No
External Mounting Capability	No
Tunnel Capability	Yes

SE300/300TC

SE300 Tunnel bow/stern thruster, 48V

Spare parts (valid from 2022-05-02)



SLEIPNER

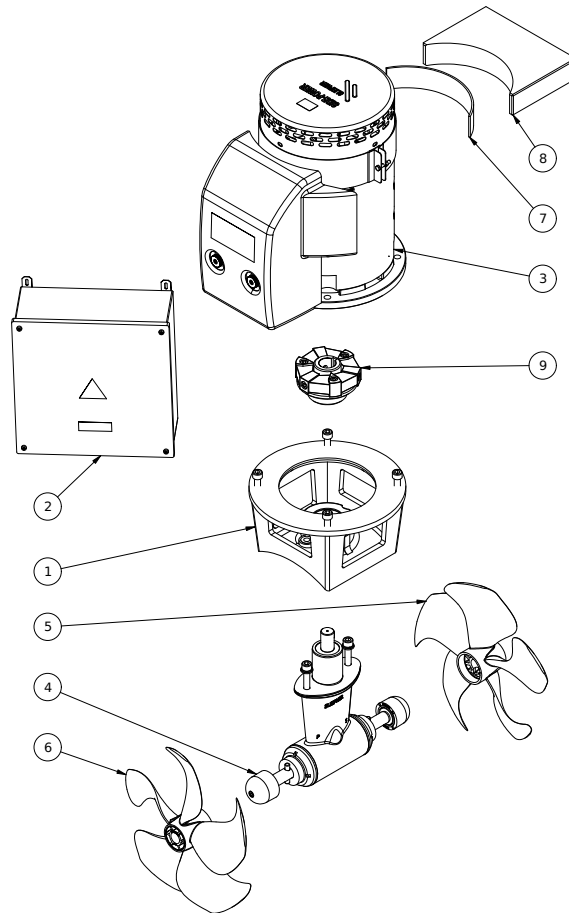

#	Quantity	Name	Item Code	Description
1	1.00	Bracket	20 0502	Complete motor bracket SE300
2	1.00	Voltage conversion box	20124A	Voltage conversion unit 24V-48V
3	1.00	Electric motor	20 0101 48	Electric motor for thruster SE300TCI-48,complete
4	1.00	Gearleg	20 0602-U	Complete gearleg SE300 w/out propeller
5	1.00	Q-Propeller	SM-130945	Thruster propeller SE300,Q/RH prop
6	1.00	Q-Propeller	SM-130943	Thruster propeller SE300,Q/LH prop
7	1.00	Gasket	20 1313	Gasket for gearleg installation in tunnel, SP220
8	1.00	Support bracket for motor	20 1274	Motor bracket SP200/220/285
9	1.00	Flexible coupling	20 1450	Flexible coupling SP220/285

The installer alone has responsibility for the installation of the spare parts. Side-Power only warranty the spare parts supplied only.

The information given in the document was correct at the time it was published. However, Sleipner Motor AS can not accept liability for any inaccuracies or omissions it may contain. Continuous product improvement may change the product specifications without notice. Therefore, Sleipner Motor AS can not accept liability for any possible differences between product and document.