

IMNASA PFD

Service Instruction

INFLATABLE PERSONAL FLOTATION DEVICE (PFD)

C type inflatable lifejacket

S type inflatable lifejacket

F type inflatable lifejacket

SOLAS inflatable lifejacket

WARNING!

This PFD will not float you without inflation. Each CO₂ inflator body will only inflate the PFD once. You must rearm this PFD after each use of the CO₂.

SERVICE INSTRUCTIONS(Every two years):

1. 8 hours leaking test

Fully oral inflate the PFD, if a pressure guage is used, set it to 1 PSI or 0.07bar. Let it stay for 8 hours, check the life jacket if significant deflation.

2. If your life jacket have leaking problem.

2.1 Leaking from Valve core

Unscrew the metal nut which is on the inflator, unscrew the valve core which is assembled in the brass seat, replace it with a new one. insert the new valve core and tight it with torque tool, the torque is **5-6 in.lb(0.57~0.68N.m)**. Tight the metal nut back with torque tool, the torque is **23-25 in.lb(2.6~2.82N.m)**.

2.2 Leaking from CO2 inflator

Unscrew the metal nut which is on the inflator, assembly with new CO2 inflator, **Make sure there are o-ring on each side of the inflator.** tight the metal nut with torque tool, the torque is **23-25 in.lb(2.6~2.82N.m)**..

2.3 Leaking from chamber.

Scrap the life jacket.

2.4 Leaking from oral inflator

Fully inflate the chamber, put the oral inflator under water, push the valve several times to let air push the debris out of the way. And check leaking again, if the leaking still exist, scrap the life jacket.

3. Auto inflator bobbin changing

The bobbin has to be replaced with a new one, with the expiry date not less than two years, please follow rearming instruction.

4. CO2 cylinder checking

4.1 Check if any corrosion, replace it following rearming instruction.

4.2 Weight it and compare the weight with the gross weight indicated on the cylinder, the variation should be within 1 g, replace it following rearming instruction

Caution: Please pierce the scraped cylinder before discarding it.

Re-arming Instructions

Re-arming the UML inflators after firing

Note: Rearming must follow the sequence below .

The charge of the CO2 cylinder for level 150N jacket is 33 gram and 60 gram for level 275N life jacket.

UML MANUAL INFLATOR

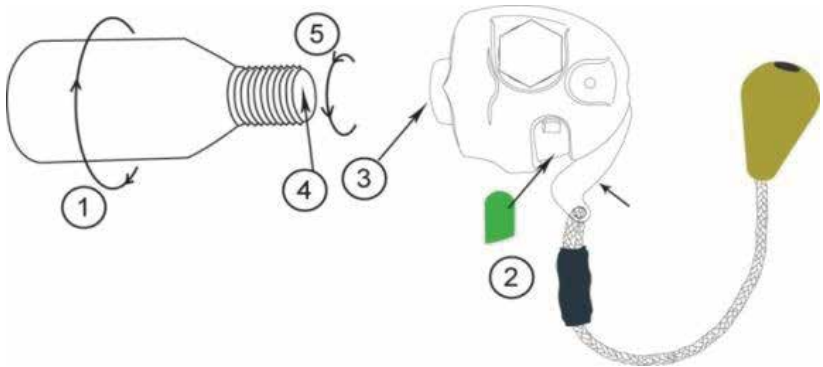

Step 1: Unscrew used CO₂ cylinder in a counterclockwise direction and immediately discard. Do not insert new cylinder at this time.

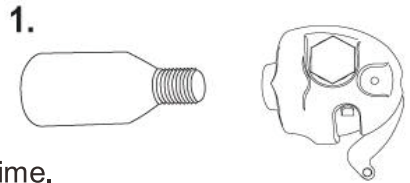

To avoid confusion later in the rearming process, we suggest you throw away the old CO₂ cylinder now.

Step 2: Close manual inflator arm within inflator body and carefully insert a new green indicator tab so that it fully covers the red semi-circle on the body.

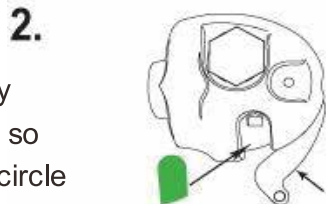

Step 3: Look into threaded cylinder receiver and view the gasket. If worn, contact [Leonsports Repair Facility](#).

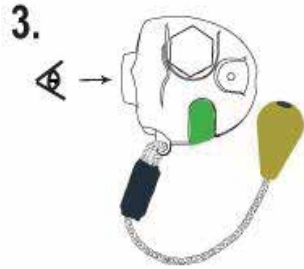

Step 4: Inspect the face of the new cylinder. Be sure it is smooth and has no holes or scratches. There is a gross weight on the cylinder. If you have any questions about cylinder integrity, weight the cylinder on a small scale, such as a postage scale. Compare the weight printed on the cylinder to the actual weight. If they do not match, get another new cylinder

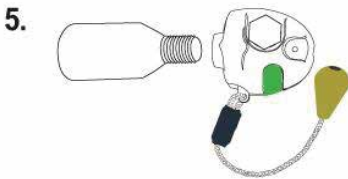
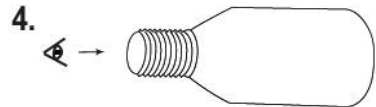

Step 5: Screw new cylinder in a clockwise direction firmly into the inflator. Do not over-tighten, but ensure the fit is tight, if a torque wrench is used, set the torque to **23-25 in.lb(2.6~2.82N.m)**.

Step 6: Check the inflator arming indicator every boating trip. The indicator and cylinder tightness tell you if there is a need for service. Check the cylinder face regularly to ensure it is not punctured. Be sure cylinder is screwed in tight.

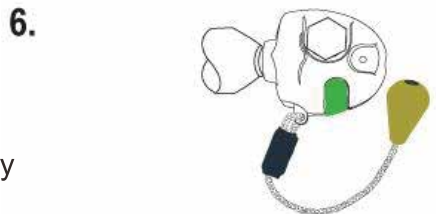

UML AUTOMATIC/MANUAL INFLATOR (MK5)

Step1: Unpack or open the lifejacket so that the manual/automatic inflator is visible.

Step2: Remove gas CO₂ cylinder by firmly rotating cylinder counterclockwise. Discard cylinder.

Step3: Remove cap by turning counterclockwise. Discard cap.

Step4: Check the date on the bobbin in the rearm kit. The date should not be over two years from today's date.

Step5: Check cap bottom to be sure it is green

Step6: IMPORTANT

Install cap by screwing clockwise until it meets the inflator body Shoulder.(No gap)

Step7: Install cylinder by rotating clockwise into inflator until cylinder is secured firmly in inflator. if a torque wrench is used, set the torque to **23-25 in.lb(2.6~2.82N.m)**.

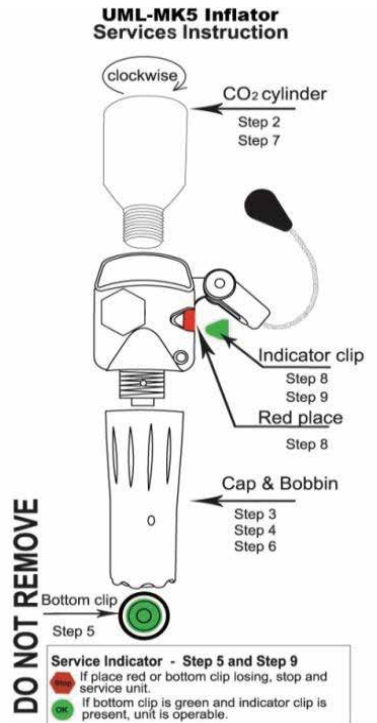

Step8: Place indicator clip over red lever by aligning the arms on the clip with the slots in the inflator. Push firmly in the middle of the clip to snap in place.

Step9: Check to be sure service indicator is green and green indicator clip is firmly attached.

Rearm parts for service station

Part Number	Description
60832	UML Auto inflator MK5
60833	UML Mini Manual inflator
61118	Bobbin for MK5 Auto inflator
60835	Green Indicator clip for MK5 Auto inflator
60834	Green Indicator clip for Manual inflator
60993	33gCO2 tank
60994	60gCO2 tank
61247	Valve core

Rearm kits for end user

Part number	Description
61248	Rearm kits for UML MK5 Auto inflator(150N)
61249	Rearm kits for UML MK5 Auto inflator(275N)
61250	Rearm kits for UML Mini Manual inflator(150N)
61251	Rearm kits for UML MK5 Manual inflator(275N)

Air leakage test for SOLAS lifejacket

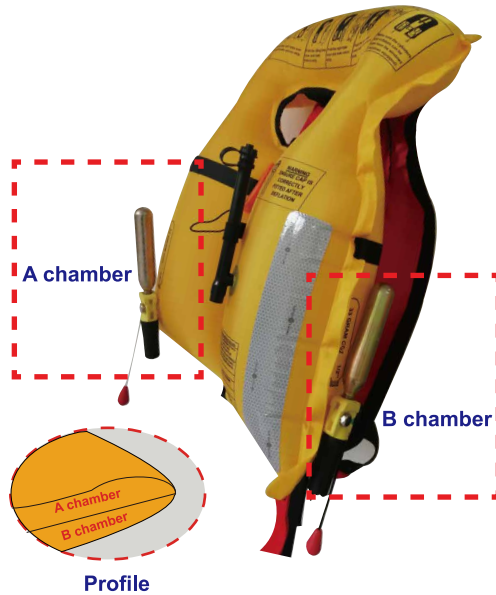

The solas lifejacket have two chambers:
A and B, the test step :

1st: Inflate the A chamber to 1 psi,
keep the oral tube open on the chamber B
(Plug with a stopper,
the 10mm hollow tube is better).

This step is to test the leak for the chamber A.
Test the inner pressure after 8 hours.



2nd: Deflate the A chamber till there is no Air in A chamber.

3rd: Inflate the B chamber to 1psi,
no need to do anything on the oral tube on chamber A .

The opv on the oral tube is 3.5 PSI,
so over 3.5 PSI will release the air.

INFLATABLE PERSONAL FLOTATION DEVICE (PFD)

IMNASA
www.imnasa.com