

2026

MTX SERIES

The Marine Town eXpression Series

THE NEW
MTX
S E R I E S

The Marine Town eXpression Series



The Marine Town eXpression Series epitomizes innovation using refined technology.
Our array of color options empowers the builders to express a unique aesthetic.

We are dedicated to crafting leading edge products that are tailored to your distinctive style!



PRODUCT INFORMATION

- Our MTX-Series, stands for Marine Town eXpression Series.
The MTX Series is produced using a distinctive technology, setting it apart from conventional methods such as painting or powder coating. All our MTX products meet rigorous standards, including :
 1. UV Resistance and Condensation Test.
 2. Endurance of 500 hours in a salt spray test.
 3. Cross-hatch adhesion tests conforming to ASTM classification 5B, the highest possible standard.

- Marine Town products are primarily stainless steel 316. However, variations in material may occur to accommodate particular product demand or function. **Material used in components such as tubing, plates and miscellaneous accessories such as screws, washers, nuts, pins, and springs, etc. are generally made from stainless steel 304.**

- Each product will have a size tolerance under casting process or secondary machining such as polishing. Specification differences from the catalog under these circumstances will be acceptable.

- Marine Town reserves the right to adjust specifications in order to improve the product function without prior notification to customers.

- Our marine grade stainless steel products are superior in corrosion resistance. However, the protective surface can be damaged through mechanical means, heat or chemical damage.

Marine Town encourages regular and thorough cleaning of all stainless steel hardware to extend the product life. **⚠ Caution: Avoid harsh chemical cleaners that may accelerate rust and corrosion.**

- Damage to products resulting from abrasive or harsh cleaning practices as well as general long term use outside the warranty period will not be covered under the Marine Town warrant policy.

- Selected products are available in limited stock, while others are made-to-order with minimum quantity requirements. Contact us for availability and details!

EXCLUSIVE NEW MTX SERIES SELECTIONS

Experience the next level of customization with Marine Town's diverse selection of finishes. Engineered to enhance your boat's visual appeal while seamlessly combining practicality with elegance.



MATTE BLACK



GLOSSY BLACK



SILVER

HOW TO ORDER

CODE	FINISH OPTIONS	ITEM NO.
-B	Matte Black	Bulk No. - B
-P	Glossy Black	Bulk No. - P
-S	Silver	Bulk No. - S

CONTENTS

04

CABINET HARDWARE & LOCK

- Slam Latch
- Compression Latch
- Barrel Bolt
- Spring Loaded Door Latch
- Position Slide Latch
- Cabinet Latch / Drawer Latch
- I Locker
- Paddle Latch
- Over Center Latch
- Cabinet Knob
- Head Door Latch



19

PLUMBING

- Drain Plug
- Mega Pro Thru Hull

22

ENGINE SYSTEM

- Tank Vent



23

DECK HARDWARE

- Heavy Duty Fingergrip Handle
- Drawer Handle
- Grab Handle
- Folding Coat Hook
- Foldaway Pad Eye
- Handrail Fitting
- Bow & Stern Eye
- Cleat

31

SEATING & BIMINI HARDWARE

- Armrest Bracket
- Sunshade Socket

35

HINGES

- Covered Friction Hinge
- Friction Hinge
- Butterfly Hinge
- Cast Hinge

GRAND SLAM LATCH 2"

Built with precision, crafted for lasting durability.



GRAND SERIES-
MINI SLAM LATCH 1-3/8"

Stainless Steel 316

- Smaller self-closing latch.
- Anti-rattle design incorporates double springs.
- Stainless steel 316 slide built to endure high-speed impacts under way.
- Reversible backing plate for wide range of door thickness.
- Included gasket eliminates the need for caulking.

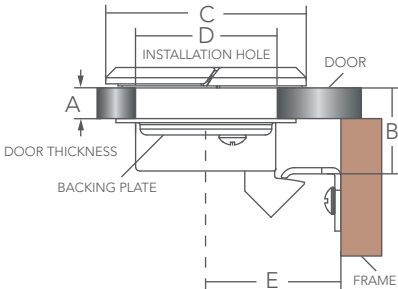

BULK NO.	SCREW SIZE	
	LATCH BODY	STRIKE
0207801	#6 (included)	M4 or #8 (not included)
0207802	#8 (included)	M4 or #8 (not included)
0207851	#8 (included)	M4 or #8 (not included)

Bulk No.	Shape	Model	A mm	B mm	C mm	D mm	E mm
0207801	Round	W/O Lock	8~19(5/16"~3/4")	22(7/8")	49(1-15/16")	35(1-3/8")	33(1-5/16")
0207802	Round	W/ Lock	8~19(5/16"~3/4")	22(7/8")	49(1-15/16")	35(1-3/8")	33(1-5/16")
0207851	Square	W/O Lock	8~19(5/16"~3/4")	22(7/8")	49(1-15/16")	35(1-3/8")	33(1-5/16")
9105511-V1	3mm(1/8") Spacer						
9707938	Stainless Steel 304 Universal MT Key						

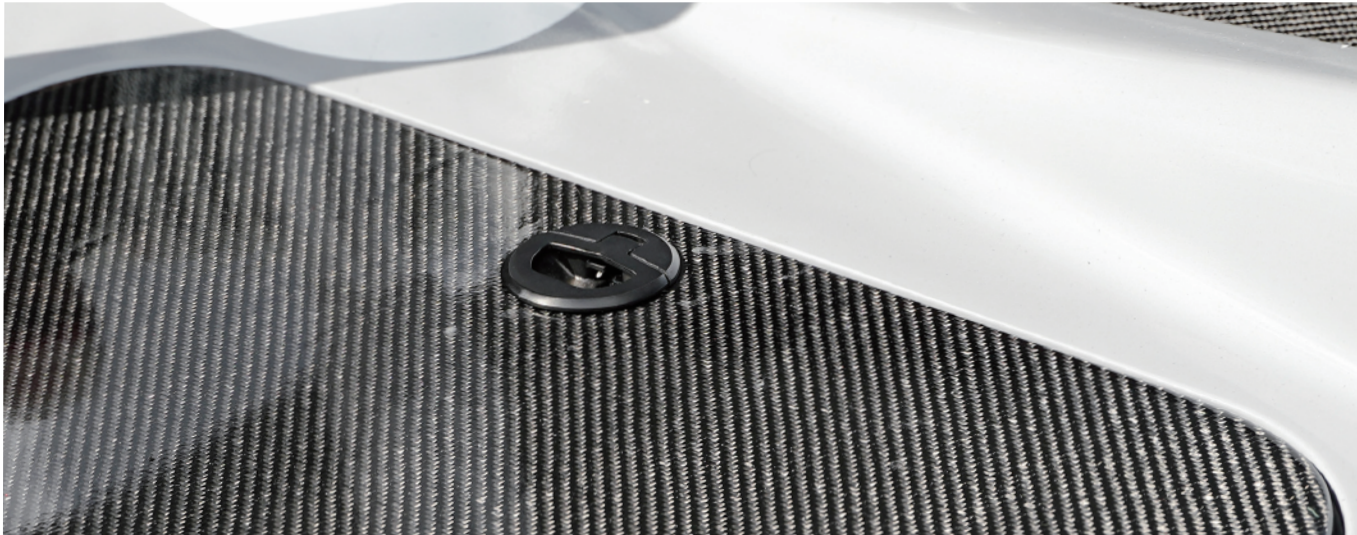

GRAND SERIES- SLAM LATCH 1-3/4"

Stainless Steel 316

- Larger handle opening for comfortable grip.
- Anti-rattle design incorporates double springs and plastic slide to ensure quiet operation, even underway.
- Adjustable slide accommodates minor adjustments following installation to ensure rattle-free operation.
- Reversible backing plate for wide range of door thickness.
- Included gasket eliminates the need for caulking.
- #6 installation screws are included.
- Strike screw size M4 or #8 (not included).



SLIDE ADJUSTMENT INSTRUCTION

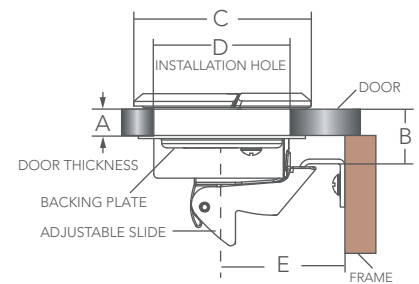
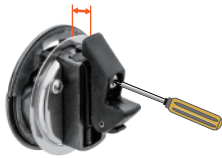

Bulk No.	Shape	Model	A mm	B mm	C mm	D mm	E mm
1007811	Round	W/O Lock	9~22(3/8"~7/8")	19~25(3/4"~1")	57(2-1/4")	45(1-3/4")	40(1-9/16")
1007812	Round	W/ Lock	9~22(3/8"~7/8")	19~25(3/4"~1")	57(2-1/4")	45(1-3/4")	40(1-9/16")
1007871	Square	W/O Lock	9~22(3/8"~7/8")	19~25(3/4"~1")	57(2-1/4")	45(1-3/4")	40(1-9/16")
9305351-V1	8mm(5/16") Spacer						
1007811-V11	3mm(1/8") Spacer						



GRAND SERIES- SLAM LATCH 2"



Stainless Steel 316 Body & Plastic Slide

- Designed with a 2" installation hole, it's the perfect direct replacement for most common applications.
- Larger handle opening for comfortable grip.
- Anti-rattle design incorporates double springs and plastic slide to ensure quiet operation, even underway.
- Adjustable slide accommodates minor adjustments following installation.
- Reversible backing plate for wide range of door thickness.
- Included gasket eliminates the need for caulking.
- 3mm spacer and #8 installation screws are included.
- Strike screw size M4 or #8 (not included).



SLIDE ADJUSTMENT INSTRUCTION

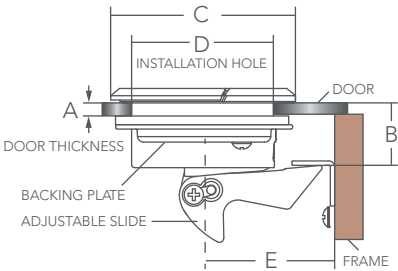
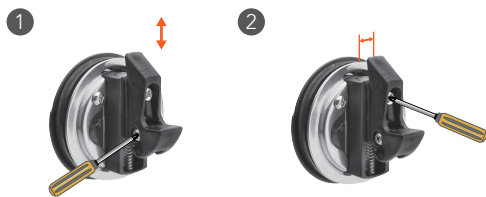

Bulk No.	Model	A mm	B mm	C mm	D mm	E mm
0207803	W/O Lock	6~22(1/4" ~7/8")	22~28(7/8" ~1-1/8")	63(2-1/2")	51(2")	42(1-5/8") or 48(1-7/8")
0207804	W/ Lock	6~22(1/4" ~7/8")	22~28(7/8" ~1-1/8")	63(2-1/2")	51(2")	42(1-5/8") or 48(1-7/8")

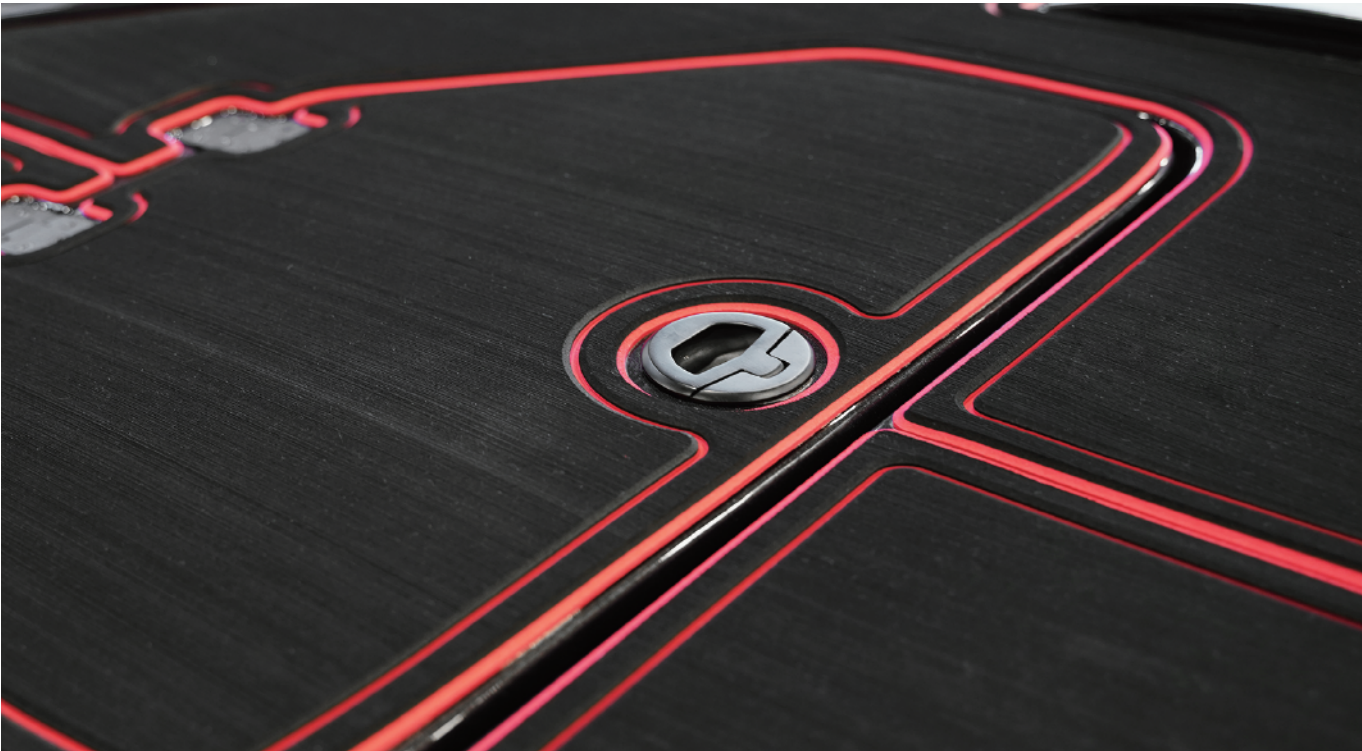

NEW

GRAND SERIES- SLAM LATCH 2"



Stainless Steel 316

- Designed with a 2" installation hole, it's the perfect direct replacement for most common applications.
- Anti-rattle design incorporates double springs.
- Stainless steel 316 slide built to endure high-speed impacts under way.
- Adjustable slide accommodates minor adjustments following installation.
- Reversible backing plate for wide range of door thickness.
- Included gasket eliminates the need for caulking.
- 3mm spacer and #8 installation screws are included.
- Strike screw size M4 or #8 (not included).

PATENTED



SLIDE ADJUSTMENT INSTRUCTION

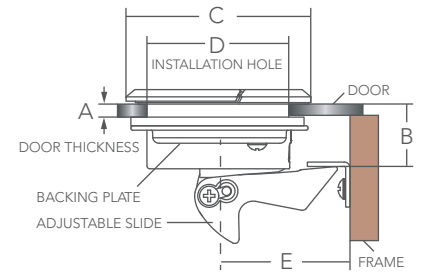
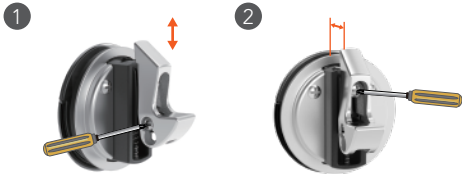

Bulk No.	Model	A mm	B mm	C mm	D mm	E mm
1207823	W/O Lock	6~22(1/4"~7/8")	22~28(7/8"~1-1/8")	63(2-1/2")	51(2")	42(1-5/8") or 48(1-7/8")
1207824	W/ Lock	6~22(1/4"~7/8")	22~28(7/8"~1-1/8")	63(2-1/2")	51(2")	42(1-5/8") or 48(1-7/8")



GRAND SERIES-
COMPRESSION LATCH 2"

- Stainless Steel 316
- Spring loaded, anti-rattle design.
 - Larger handle opening for comfortable grip.
 - Detent handle ensures positioning after a 90° turn.
 - Ideal for gasketed hatches.
 - #8 installation screws and watertight gasket are included.



1007831-B



1007832-B

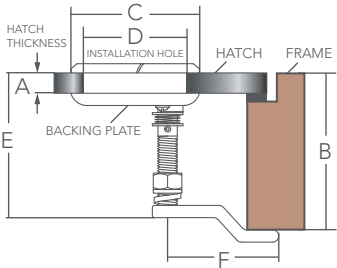

Bulk No.	Model	A mm	B mm	C mm	D mm	E mm	F mm
1007831	W/O Lock	1~20(1/16"~13/16")	25~76(1"~3")	65(2-9/16")	51(2")	71(2-13/16")	54(2-1/8")
1007832	W/ Lock	6~20(1/4"~13/16")	25~76(1"~3")	65(2-9/16")	51(2")	71(2-13/16")	54(2-1/8")



GRAND SERIES- SQUARE COMPRESSION LATCH 2"

Stainless Steel 316

- Spring loaded, anti-rattle design.
- Larger handle opening for comfortable grip.
- Detent handle ensures positioning after a 90° turn.
- Ideal for gasketed hatches.
- #8 installation screws and watertight gasket are included.



1007833-B



1007834-P

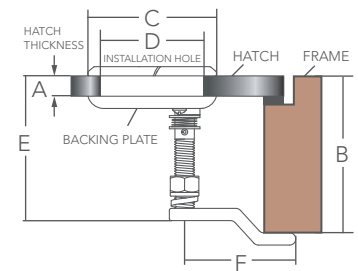

Bulk No.	Model	A mm	B mm	C mm	D mm	E mm	F mm
1007833	W/O Lock	1~20(1/16"~13/16")	25~76(1"~3")	65(2-9/16")	51(2")	71(2-13/16")	54(2-1/8")
1007834	W/ Lock	6~20(1/4"~13/16")	25~76(1"~3")	65(2-9/16")	51(2")	71(2-13/16")	54(2-1/8")



DELUXE BARREL BOLT

Stainless Steel 316 & Plastic

- Clean and elegant appearance with snap-on SS316 cover to conceal installation fasteners.
- Knob can be positioned to keep the door open.
- Stainless steel slide works smoothly on plastic body.
- The spring-loaded slide effortlessly self-latches to ensure constant engagement and no rattle.
- Screw size of 0407121/2: M4 or #8.
- Screw size of 0407123: M4 or #8 for latch body, and M3 or #6 for strike.



0407121-P



0407121-B



0407123-B

Bulk No.	Strike	A mm	B mm	C mm	D mm
0407121	Standard	31(1-1/4")	67(2-5/8")	22(7/8")	31(1-1/4")
0407122	None	31(1-1/4")	67(2-5/8")	-	-
0407123	Flush	31(1-1/4")	67(2-5/8")	15(9/16")	35(1-3/8")

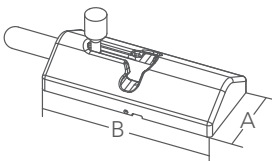
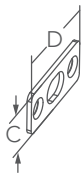
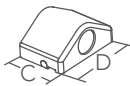

DELUXE SLAM BARREL BOLT

Stainless Steel 316 & Plastic

- Angled barrel design mimics slam latches for worry free closing.
- Clean and elegant appearance with snap-on SS316 cover to conceal installation fasteners.
- Knob can be locked in position to keep latch open.
- Stainless steel slide works smoothly on plastic body.
- The spring-loaded slide effortlessly self-latches to ensure constant engagement and no rattle.
- Optional strikes available for various door configurations.
- Screw size of 0507151: M4 or #8.
- Screw size of 0507157: M4 or #8 for latch body, and M3 or #6 for strike.

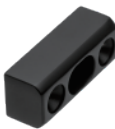

0507151-B



0507157-B

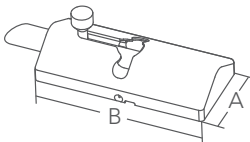
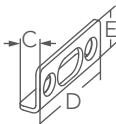
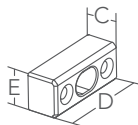

Bulk No.	A mm	B mm	C mm	D mm	E mm
0507151	31(1-1/4")	67(2-5/8")	13(1/2")	38(1-1/2")	15.5(5/8")
0507157	31(1-1/4")	67(2-5/8")	8(5/16")	38(1-1/2")	16(5/8")

SPRING LOADED DOOR LATCH



9021213-B

Stainless Steel 316 & Nylon Slide

- Contemporary appearance with no visual mounting screws.
- Self-latching with nylon slide.
- The slide is reversible by removing the latch knob, reversing the slide and re-installing the knob.
- Screw size M4 or #8.

Bulk No.	A mm	B mm	C mm	D mm
9021213	73(2-7/8")	19(3/4")	27(1-1/16")	30(1-3/16")

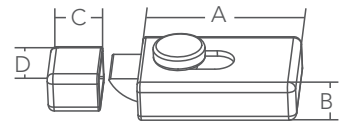

POSITION SLIDE LATCH

- Stainless Steel 316 & Plastic
- Slide latch designed with open and closed detent.
 - Smooth low effort slide design.
 - Comfortable slide grip.
 - Available with two strike options.
 - Screw size for latch body M5 or #10.
 - Screw size for strike M4 or #8.

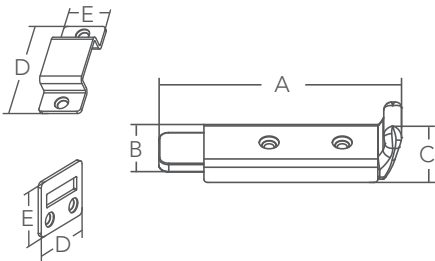
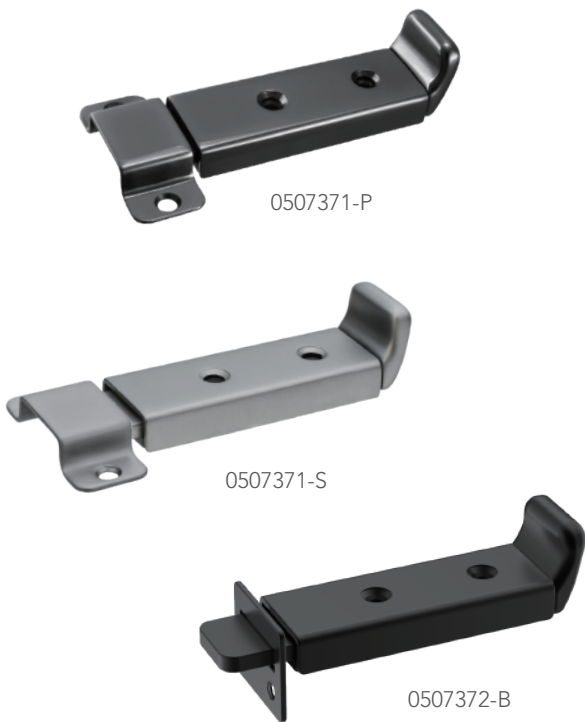

Bulk No.	Strike	A mm	B mm	C mm	D mm	E mm
0507371	Standard	123(4-13/16")	32(1-1/4")	30(1-3/16")	60(2-3/8")	25(1")
0507372	Flush	123(4-13/16")	32(1-1/4")	30(1-3/16")	38(1-1/2")	32(1-1/4")

CABINET DOOR/ DRAWER LATCH

- Stainless Steel 316 Knob & Nylon
- Ideal for use on cabinet door, drawer, glove box, tackle drawer, overhead door, etc.
 - Easy installation.
 - Door/drawer can be opened and locked securely by operating the knob.
 - Large stainless steel 316, easy-grip knob.
 - Pull to open, push to latch.

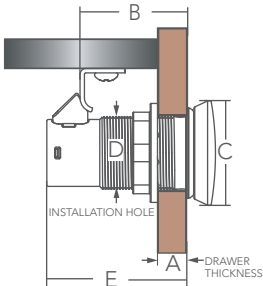
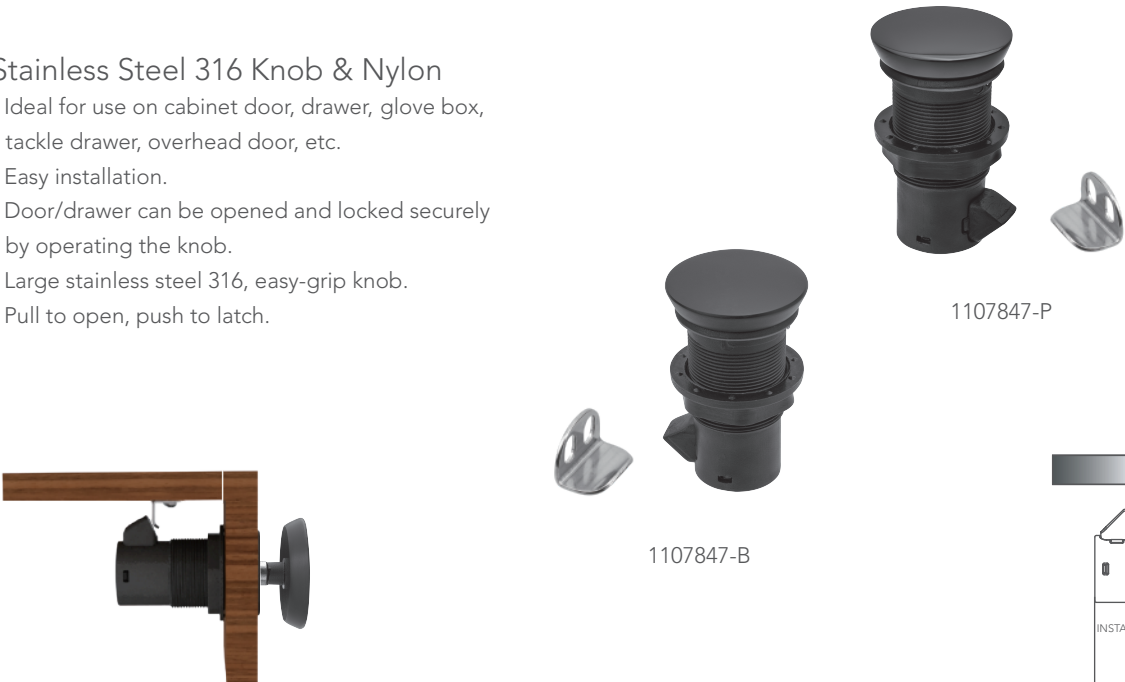

Bulk No.	Knob Type	A mm	B mm	C mm	D mm	E mm
1107847	Pull	5~25(3/16"~1")	37(1-7/16")	36(1-7/16")	25(1")	48(1-7/8")

NEW

I LOCKER



1207522-P



1207522-B

Stainless Steel 316

- Functions as a drawer or cabinet stop to ensure secure closure, even underway.
- Ideal for use on small cabinets and discreet storage compartments.
- Easy installation with hidden fastener design for clean appearance.
- Detent allows fixed positioning with 90° rotation.
- Screw size M4 or #6.

Bulk No.	A mm	B mm	C mm
1207522	50.8(2")	19(3/4")	13(1/2")

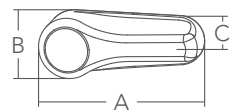

PADDLE LATCH

Stainless Steel 316

- Self-closing latch designed for inconspicuous mounting. Ideal for interior cabinets.
- Designed for installation on the outside of the application to maximize usable space within cabinets and compartments.
- Slots and off-center strike incorporated to facilitate minor adjustments following installation.
- Built-in marking hole to ensure proper alignment of strike during installation.
- Screw size M4 or #6.



Marking Hole for Strike

0607487-B



0807489-B

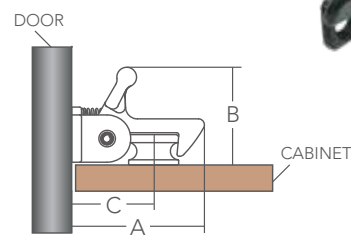

Bulk No.	Strike	A mm	B mm	C mm	D mm	E mm
0607487	Plastic	34(1-5/16")	24(15/16")	21(13/16")	50(2")	12(1/2")
0807489	SS316	34(1-5/16")	25.4(1")	21(13/16")	75(2-15/16")	12(1/2")

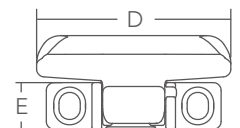

OVER CENTER LATCH

Combining security and style in one sleek design.



OVER CENTER LATCH



9907881-P



0607981-B

Stainless Steel 316

- Heavy duty cast construction with strong holding power.
- Designed to fit various applications for a tight seal on any compartment lid.
- Off-center strike can be rotated to achieve desired catch tension.
- 0607981/3: Slot hole incorporated in housing to facilitate minor adjustments following installation.
- Stainless steel mechanism presents smooth and low profile appearance in the closed position.
- Includes a PVC installation jig to ensure precise strike alignment.

PATENTED

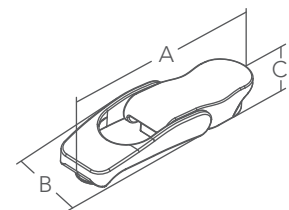

Bulk No.	Model	Lock	A mm	B mm	C mm	Screw Size	
						Latch	Strike
9907881	Standard	W/O Lock	82(3-1/4")	25(1")	15(9/16")	M4 or #8	M4 or #8
0607981	Standard	W/O Lock	106(4-3/16")	32(1-1/4")	19(3/4")	M5 or #10	M6 or 1/4"
0607983	Standard	W/ Lock	106(4-3/16")	32(1-1/4")	19(3/4")	M5 or #10	M6 or 1/4"
9907881-G	PVC Installation Jig for 9907881						
0607981-G	PVC Installation Jig for 0607981/3						

INSTALLATION INSTRUCTION

1

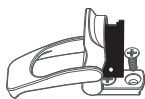

Force the spring base to the open position by sliding the jig into the open latch. Mount the latch body.

2



Slide in the strike jig.

3



Mark the strike hole.

4



Install the strike and rotate for desired tension.



OVER CENTER LATCH W/ 90° STRIKE



9907882-P



- Stainless Steel 316
- Heavy duty cast construction with strong holding power.
 - Designed to fit various applications for a tight seal on any compartment lid.
 - Off-center strike can be rotated to achieve desired catch tension.
 - Stainless steel mechanism presents smooth and low profile appearance in the closed position.

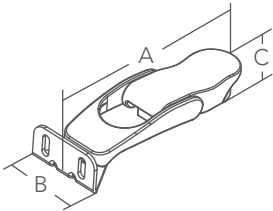

Bulk No.	Lock	A mm	B mm	C mm	Screw Size	
					Latch Base	Strike
9907882	W/O Lock	91(3-9/16")	32(1-1/4")	15(9/16")	M4 or #8	M3 or #6

CABINET KNOB

- Stainless Steel 316
- Crafted from stainless steel 316, ensuring durability.
 - Ergonomically designed for a comfortable grip.



9321250-1-P



9321250-2-A-B

Bulk No.	A mm	B mm	Screw/Thread
9321250-1	21(13/16")	14(9/16")	M4
9321250-2	21(13/16")	14(9/16")	M4 x 0.7P
9321250-1-A	21(13/16")	14(9/16")	#6
9321250-2-A	21(13/16")	14(9/16")	#6 - 32

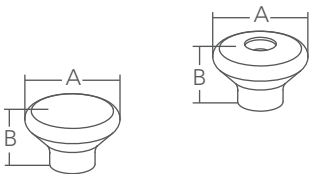

HEAD DOOR LATCH

Stainless Steel 316 & Nylon

- The nylon slide can be adjusted in angle and length to achieve the desired engagement with a maximum engagement of 15mm (5/8").
- Fits wide range of door thickness.
- A spacer block may be required (not provided) between the door and underside of the inside latch body to acquire desired slide engagement to the door frame.
- The inner beveled end of the slide must be oriented up in order for the lock to function properly.
- Screw size M5 or #10.



0407407-B



0407407-9-S

INSIDE



OUTSIDE

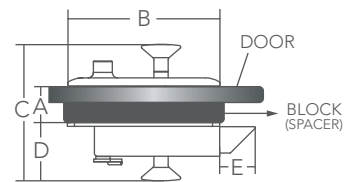

Bulk No.	A mm	B mm	C mm	D mm	E mm
0407407	19~25.4(3/4"~1")	107(4-3/16")	90(3-9/16")	41(1-5/8")	18~33(11/16"~1-5/16")
0407407-9	25.4~38(1"~1-1/2")	107(4-3/16")	100(3-15/16")	41(1-5/8")	18~33(11/16"~1-5/16")



DRIPLESS DRAIN PLUG

Dripless lip to prevent hull staining
-the difference is in the details!



NEW

DRIPLESS DRAIN PLUG

Stainless Steel 316

- Equipped with a dripless lip to prevent hull staining.
- Allows quick drainage.
- Housing is designed to capture plug when unscrewed to prevent loss.
- Plug can be removed for cleaning.
- Silicone rubber gasket included.
- Screw size M4 or #8.



1103111-B



1103113-B

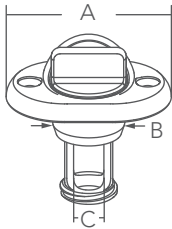

Bulk No.	A mm	B mm	C mm
1103111	55(2-3/16")	24(15/16")	12(1/2")
1103113	64(2-1/2")	31(1-1/4")	19(3/4")

OVAL DRAIN PLUG

Stainless Steel 316

- Allows quick drainage.
- Housing is designed to capture plug when unscrewed to prevent loss.
- Plug can be removed for cleaning.
- Silicone rubber gasket included.
- Screw size M4 or #8.



9004266-B



9004269-B

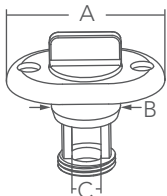

Bulk No.	A mm	B mm	C mm
9004266	55(2-3/16")	24(15/16")	12(1/2")
9004269	64(2-1/2")	31(1-1/4")	19(3/4")

MEGA PRO THRU HULL W/ CAST NUT



Stainless Steel 316

- Upgraded design incorporates stainless steel cast nut.
- High density marine-grade stainless steel ensures strength and prevents crevice corrosion.
- Thin wall construction to ensure maximum water flow.
- Machined inner finish reduces potential for residual debris.
- Silicone rubber gasket included.

SIDE LOAD

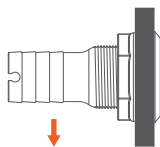

Compliance to ABYC
H-27 standard.

INSTALLATION INSTRUCTION

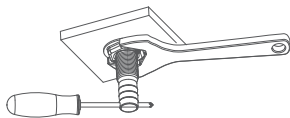

Easy, one-man installation.

Bulk No.	A mm	B mm	C mm	D mm	E mm
0603272	19(3/4")	64(2-1/2")	22(7/8")	32(1-1/4")	5~22(3/16"~7/8")
0603273	25(1")	67(2-5/8")	31.5(1-1/4")	46(1-13/16")	5~22(3/16"~7/8")
0603274	29(1-1/8")	67(2-5/8")	31.5(1-1/4")	46(1-13/16")	5~22(3/16"~7/8")
0603276	38(1-1/2")	78(3-1/16")	41(1-5/8")	59(2-5/16")	5~22(3/16"~7/8")

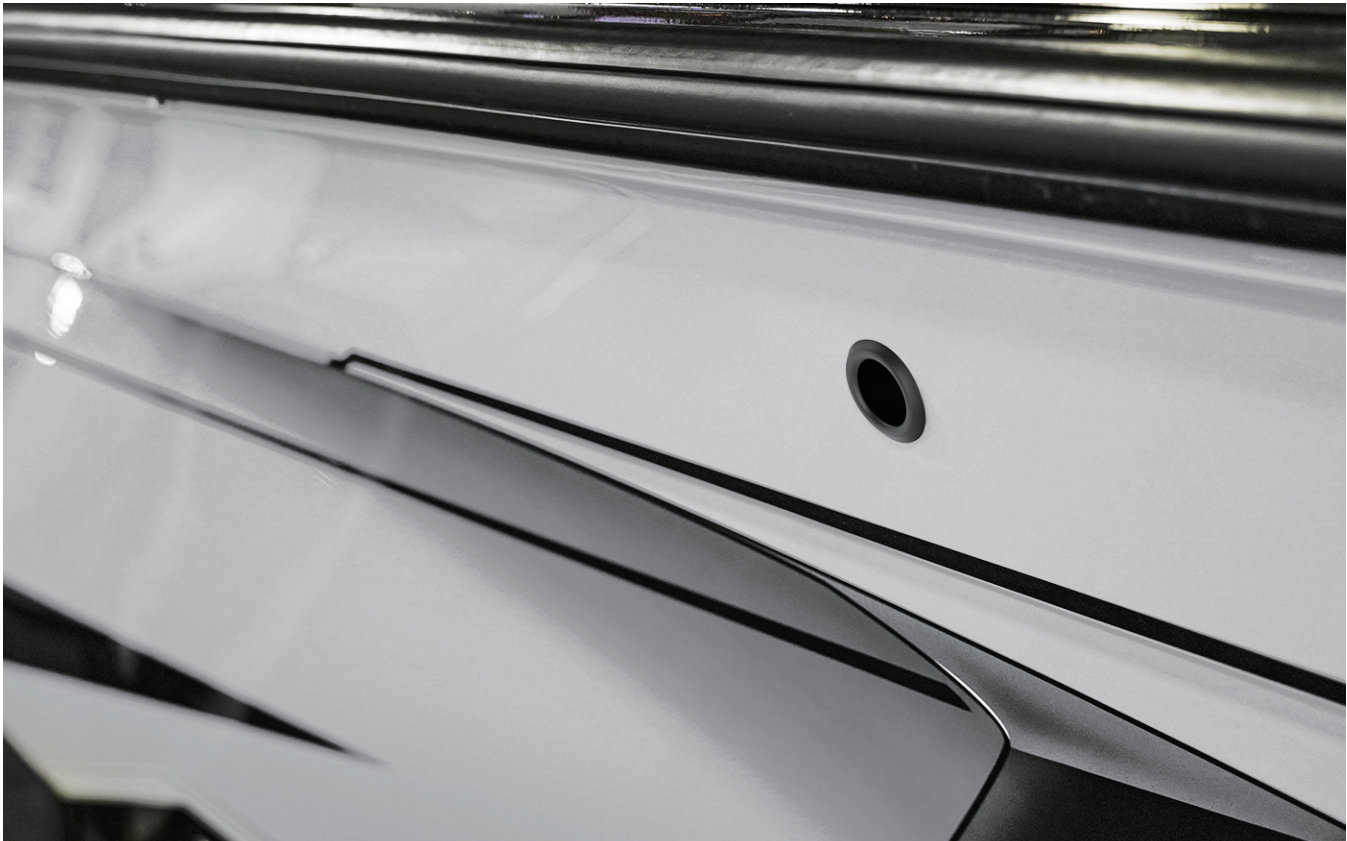
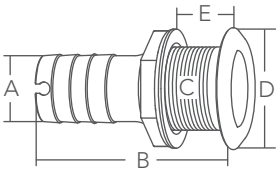

FLUSH TANK VENT



9106272-B

- Stainless Steel 316 Body & Stainless Steel 304 Cup
- Provides flush hull installation.
 - High airflow capacity.
 - Comes with a stainless steel 304 flame arrestor screen.
 - Barb up installation to prevent water ingress into the fuel tank, avoiding contamination of fuel system.
 - Suitable for thicker hull.

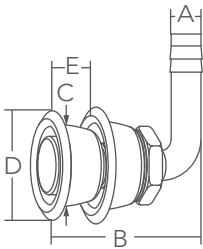

Bulk No.	Angle	A mm	B mm	C mm	D mm	E mm
9106272	90°	16.5(5/8")	70(2-3/4")	35(1-3/8")	46(1-13/16")	15~28(9/16"~1-1/8")

STALON TANK VENT

- Stainless Steel 316 Body & Nylon
- Provides flush hull installation.
 - Comes with stainless steel 304 front cup and flame arrestor screen.
 - Uses nylon backing cup and nut to save cost without compromising the vent integrity.



9106364-B

Bulk No.	Angle	A mm	B mm	C mm	D mm	E mm
9106364	90°	16(5/8")	70(2-3/4")	35(1-3/8")	46(1-13/16")	up to 15(9/16")

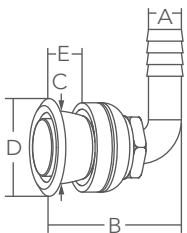

HEAVY DUTY FINGERGRIP HANDLE



9715682-S



9715682-P



9715684-A-B

Stainless Steel 316

- Heavy duty solid cast construction combines beauty and durability.
- The ergonomic design incorporates ribs to facilitate a secure and comfortable grip, even in rough conditions.
- 9715684/-A: Incorporates stainless steel 304 studs.

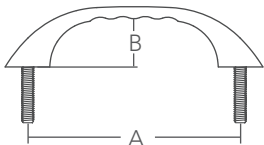
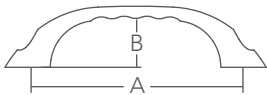

Bulk No.	Model	A mm	B mm	Screw/ Stud Size
9715682	Screw	141(5-9/16")	32(1-1/4")	M6
9715684	Stud	141(5-9/16")	32(1-1/4")	M6 x 1P x L: 37mm(1-7/16")
9715682-A	Screw	141(5-9/16")	32(1-1/4")	1/4"
9715684-A	Stud	141(5-9/16")	32(1-1/4")	1/4"-20T x L: 37mm(1-7/16")

DRAWER HANDLE

Stainless Steel 316

- Perfect for interior cabinetry on boats and motorhomes.
- Heavy duty cast construction combines beauty and durability.
- Low profile design with ample space for comfortable grip.
- Smooth edge with modern outline.
- Boss type design to maximize inner storage space.



0906736-S



0906736-P



0906736-A-B

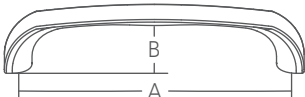

Bulk No.	A mm	B mm	Screw Size
0906736	138(5-7/16")	24(15/16")	M5 x 0.8P
0906736-A	138(5-7/16")	24(15/16")	#10-24T

GRAB HANDLE

Stainless Steel 316

- Welded and polished base design for stud type grab handle.
- Tube diameter: 25.4mm(1") x 18.2mm(3/4").



9024275-A-B



9024305-A-B

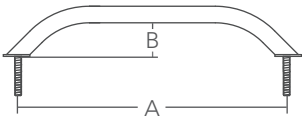

Bulk No.	A mm	B mm	Stud Size
9024275-A	219(8-5/8")	38(1-1/2")	5/16" x (L) 50mm
9024271-A	305(12")	38(1-1/2")	5/16" x (L) 50mm
9024305-A	338(13-5/16")	38(1-1/2")	5/16" x (L) 50mm
9024274-A	610(24")	38(1-1/2")	5/16" x (L) 50mm



NEW

DOUBLE FOLDING COAT HOOK



1111211-P



1111211-B

- Stainless Steel 316
- Upgrade to heavy-duty construction for extra durability.
 - Designed for hanging jackets, hats, and bags.
 - Spring-loaded hook folds flat when not in use.
 - Screw size M4 or #8.

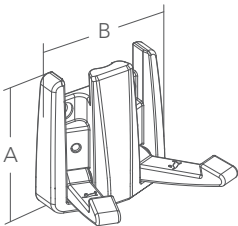

Bulk No.	A mm	B mm	Hook WLL
1111211	55(2-3/16")	52(2-1/16")	50kgf(110lbf)



FOLDAWAY PAD EYE



- Stainless Steel 316
- Anti-rattle design.
 - Strong yet compact oval base with countersunk screw holes.
 - Friction hinged eye stays in position.
 - Screw size M6 or 1/4" .

Bulk No.	A mm	B mm	C mm	WLL
9706385	70(2-3/4")	12(1/2")	60(2-3/8")	600 kgf/ 1322 lbf
9706388	100(3-15/16")	12(1/2")	60(2-3/8")	900 kgf/ 1984 lbf

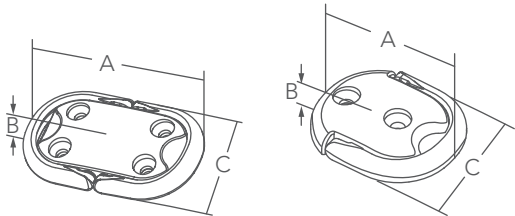

HANDRAIL FITTING 1"

- Stainless Steel 316
- Special mechanism secures railing in place as lock nut is tightened and eliminates the need for set screws.
 - Concealed fastener design for a more elegant appearance.
 - Fits 1" outer diameter handrail.
 - Stainless steel 304 washer and locking nuts are included.



0606198-P
0606198-A-P

0606196-B
0606196-A-B

Bulk No.	Model	A mm	B mm	C mm	D-Max.mm	E
0606196	End	62(2-7/16")	27(1-1/16")	32(1-1/4")	20(13/16")	M8 x 1.25P
0606198	Center	62(2-7/16")	25.4(1")	32(1-1/4")	20(13/16")	M8 x 1.25P
0606196-A	End	62(2-7/16")	27(1-1/16")	32(1-1/4")	20(13/16")	5/16"-18T x L: 31mm(1-1/4")
0606198-A	Center	62(2-7/16")	25.4(1")	32(1-1/4")	20(13/16")	5/16"-18T x L: 31mm(1-1/4")

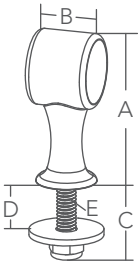

DELUXE BOW EYE



9026313-6-B



9026316-6-B

Stainless Steel 316

- Upgraded quality appearance.
- Welded and polished face plate to reduce potential rust.

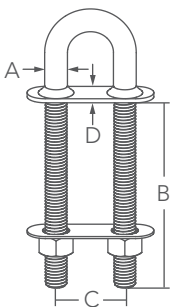

Bulk No.	A mm	B mm	C mm	D mm	Face Plate Thickness	Thread
9026313-6	12.7(1/2")	113.2(4-7/16")	46(1-13/16")	19(3/4")	3mm(1/8")	1/2"-13T
9026316-6	16(5/8")	141(5-9/16")	48.3(1-7/8")	25.4(1")	3mm(1/8")	5/8"-11T

DELUXE STERN EYE

Stainless Steel 316

- Upgraded quality appearance.
- Welded and polished face plate to reduce potential rust.



9026315-6-B



9026292-6-B

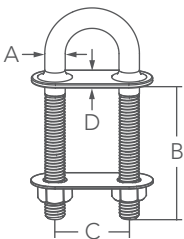

Bulk No.	A mm	B mm	C mm	D mm	Face Plate Thickness	Thread
9026292-6	12.7(1/2")	88.5(3-7/16")	46(1-13/16")	30(1-3/16")	3mm(1/8")	1/2"-13T
9026315-6	16(5/8")	140.2(5-1/2")	48.3(1-7/8")	38(1-1/2")	3mm(1/8")	5/8"-11T

HEAVY DUTY STERN EYE

Stainless Steel 316

- Upgraded quality appearance.
- Welded and polished face plate to reduce potential rust.



9107722-6-B



9107726-6-B



9107727-6-B

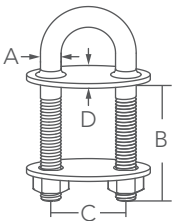

Bulk No.	A mm	B mm	C mm	D mm	Face Plate Thickness	Thread
9107722-6	12.7(1/2")	76(3")	46(1-13/16")	43(1-11/16")	3mm(1/8")	1/2"-13T
9107726-6	16(5/8")	75.2(2-15/16")	48.3(1-7/8")	83(3-1/4")	4mm(3/16")	5/8"-11T
9107727-6	16(5/8")	140(5-1/2")	48.3(1-7/8")	83(3-1/4")	4mm(3/16")	5/8"-11T



PULL UP FOLDING CLEAT



- Stainless Steel 316
- Features a clean, low profile appearance, with a large handle for easy operation.
 - Easy installation.
 - Fold-down design prevents accidental catching of lines.
 - Surface mount eliminates the need for water drainage.
 - Smooth edge to prevent rope chafing or potential for injury.

Bulk No.	Screw Size	Middle Screw	Working Load Limit
9806464	M6 or 1/4"	M4 or #8	
9806466	M8 or 5/16"	M4 or #8	
9806468	M10 or 3/8"	M5 or #10	

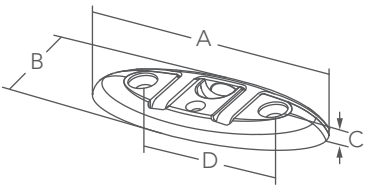

Bulk No.	A mm	B mm	C mm	D mm	WLL
9806464	115(4-1/2")	41(1-5/8")	10(3/8")	65(2-9/16")	150 kgf/ 330 lbf
9806466	155(6-1/8")	55(2-3/16")	14(9/16")	86(3-3/8")	250 kgf/ 551 lbf
9806468	202(7-15/16")	73(2-7/8")	15(9/16")	114(4-1/2")	350 kgf/ 771 lbf



CURVED CLEAT



0906376-B



0906376-B

Stainless Steel 316

- Anti-rattle design.
- Easy installation.
- Modern shape with simple outline.
- Flush appearance that covers entire cleat base when stowed.
- Unique handle design allows for comfortable operation.
- Rubber caps are available upon request to prevent water from leaking.
- Aluminum backing plate is included.
- Glossy black finish is not available.

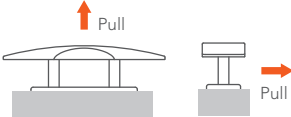

WORKING LOAD LIMIT

Bulk No.	Vertical Pull	Lateral Pull	
0906376	1000 kgf/ 2200 lbf	250 kgf/ 550 lbf	
0906378	1200 kgf/ 2640 lbf	550 kgf/ 1210 lbf	
0906380	1630 kgf/ 3586 lbf	800 kgf/ 1760 lbf	

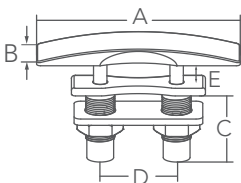

Bulk No.	A mm	B mm	C mm	D mm	E mm	Installation Hole	Grip mm
0906376	152(6")	40(1-9/16")	55(2-3/16")	57(2-1/4")	21(13/16")	25.4mm(1")	1~23.5(1/16"~ 15/16")
0906378	203(8")	43(1-11/16")	64(2-1/2")	70(2-3/4")	30(1-3/16")	25.4mm(1")	1~27(1/16"~ 1-1/16")
0906380	254(10")	51(2")	94(3-11/16")	87(3-7/16")	37(1-7/16")	32mm(1-1/4")	1~43(1/16"~ 1-11/16")

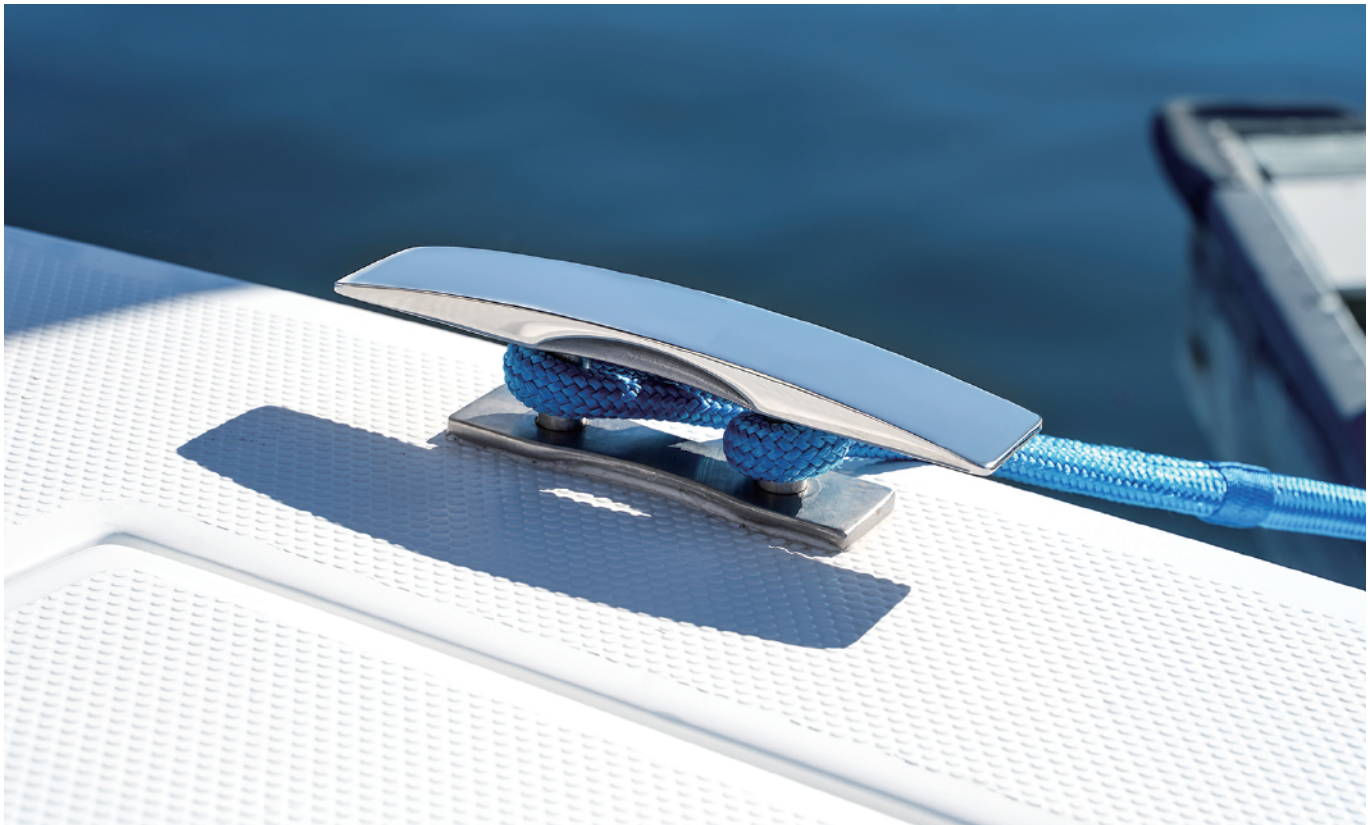

DELUXE ARMREST BRACKET



0511692-P



0511692-S

Stainless Steel 316

- Marine-grade stainless steel construction.
- Incorporates a position pin.
- Screw size M6 or 1/4".

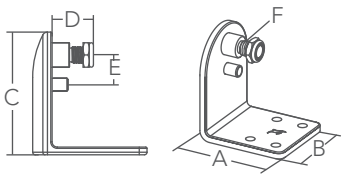

Bulk No.	Screw Hole	A mm	B mm	C mm	D mm	E mm	F
0511692	Straight Hole	89(3-1/2")	70(2-3/4")	95(3-3/4")	32(1-1/4")	23(15/16")	1/2"-13T



ARMREST BRACKET

Stainless Steel 316

- Marine-grade stainless steel construction.
- Incorporates a position pin.
- Screw size M6 or 1/4".



0411690-8-B



0411690-8-S

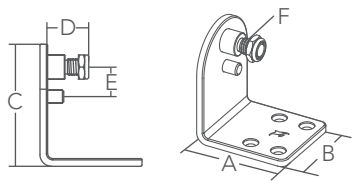

Bulk No.	Screw Hole	A mm	B mm	C mm	D mm	E mm	F
0411690-8	Countersunk Hole	80(3-1/8")	70(2-3/4")	95(3-3/4")	32(1-1/4")	23(15/16")	1/2"-13T

SUNSHADE SYSTEM SUNSHADE SOCKET

Secure installation for a wobble-free shade.



SUNSHADE SOCKET STUD TYPE



- Stainless Steel 316**
- Designed with a 15° angle to create self-tensioning of poles, ensuring secure installment.
 - Self-draining design incorporates a threaded barb for 1/2" draining hose.
 - Included seal gasket eliminates the need for caulking.
 - Wider backing cup distributes stress over a larger area when in use.
 - 0506867 & 0506867-8: Small face with low profile, ideal for boats with narrow gunnels. Requires a 28mm (1-1/8") installation hole with a 15° angle and notch hole.
 - 0806868 & 0806868-9: Wider flange provides better coverage of the installation hole. Requires a straight 35mm (1-3/8") diameter installation hole and notch hole.
 - 0506867-8 & 0806868-9: Shallow backing cup is designed to accommodate thick laminate installation sites.

PATENTED

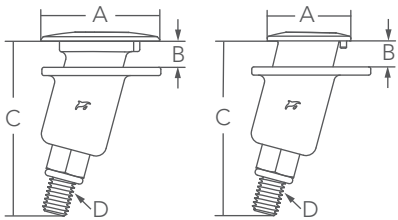

Bulk No.	Face Size	Backing Cup	A mm	B mm	C mm	D
0506867	Small	Standard	40(1-9/16")	13~22(1/2"~7/8")	85(3-3/8")	1/2"-13T
0506867-8	Small	Shallow	40(1-9/16")	27~36(1-1/16"~1-7/16")	85(3-3/8")	1/2"-13T
0806868	Big	Standard	58(2-1/4")	13~22(1/2"~7/8")	85(3-3/8")	1/2"-13T
0806868-9	Big	Shallow	58(2-1/4")	26~36(1"~1-7/16")	85(3-3/8")	1/2"-13T

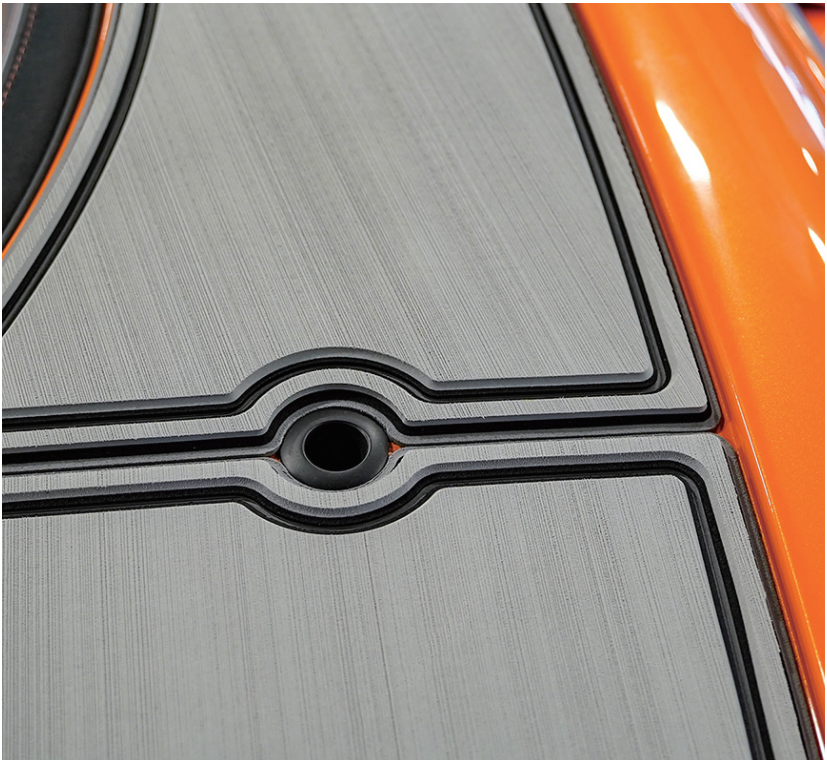

SUNSHADE SOCKET W/CAP



0506865-B



0506865-S

Stainless Steel 316

- Designed with a 15° angle to create self-tensioning of poles, ensuring secure installment.
- Anti-rattle design incorporates a rubber bushing under the cap hinge to ensure that the cap stays in the open or closed position underway.
- Cap is designed to prevent water flowing directly into the socket. However, this socket is not self-draining and must be maintained to prevent corrosion and rusting that may result from sitting water.
- Requires a 28mm (1-1/8") installation hole with a 15° angle.
- Included U-shaped backing plate is required for installation and must be thru-bolted to prevent vessel damage or injury.
- Screw size M5 or #10.
- Stainless steel 304 spacer and locking nut are included.

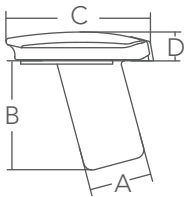

Bulk No.	A mm	B mm	C mm	D mm
0506865	28(1-1/8")	49(1-15/16")	67(2-5/8")	13(1/2")





20,000+ cycles,
minimal torque loss.

COVERED FRICTION HINGE

Holds firm with
effortless elegance.

Reliable hold,
effortless motion.

500-hour salt
spray tested.

 **Marine Town**

COVERED FRICTION HINGE



0519523-P



0519523-B

Bulk No.	Screw	Type	Size
0519523-A	#8	Barrel Down	40mm X 78mm
0519523	M4		1-9/16" X 3-1/16" Torque Range: 2.2±0.7N-m

Stainless Steel 316

- Provides constant torque throughout the entire range of motion.
- Holds door open at any desired angle without torque adjustment.
- Ideal for light-weight doors, such as overhead door, baitwell lid, glove box, interior door, anchor locker, electronic panel, etc.
- Easy installation with 3M VHB double-side tape.
- The cover can be removed by using a heat gun or hair dryer.
- Passed 10,000 times cycle test and lost less than 10% on torque;
- 20,000 times lost 20% or less only.
- Passed 500-hour salt-spray test.

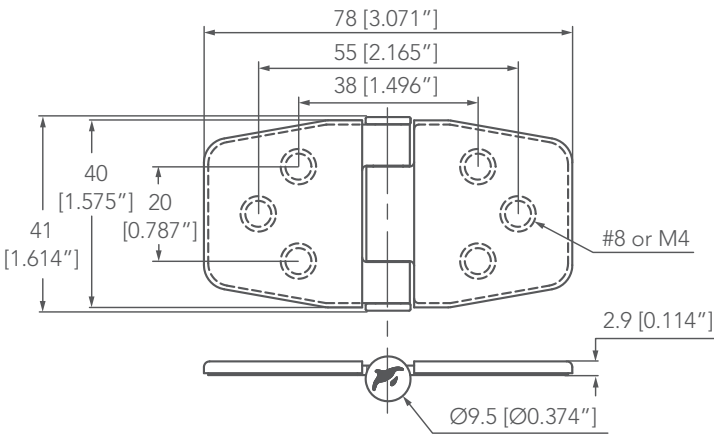



0519423-AH-B

Bulk No.	Screw	Type	Size
0519423-A 0519423	#8 M4	Barrel Up	39.6mm X 77.4mm 1-9/16" X 3-1/16" Torque Range: 1.6±0.4N-m
0519423-AH 0519423-H	#8 M4	Barrel Up	39.6mm X 77.4mm 1-9/16" X 3-1/16" Torque Range: 1.73±0.23N-m

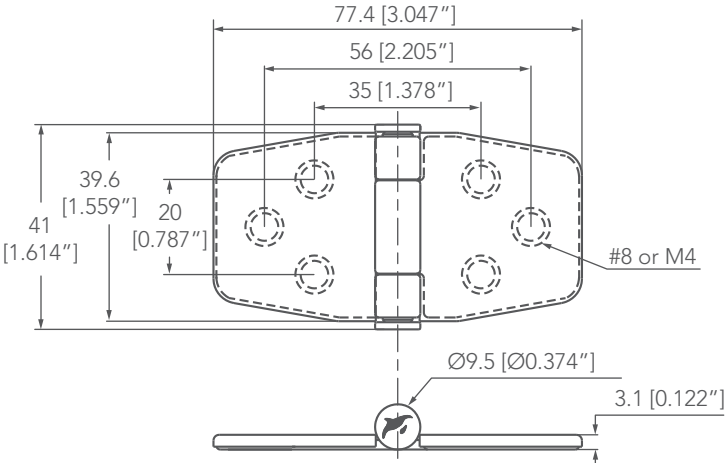

0719421-AH-B

Bulk No.	Screw	Type	Size
0719421-AH 0719421-H	#8 M4	Barrel Up	38.6mm X 39.2mm 1-1/2" X 1-9/16" Torque Range: 1.73±0.23N-m

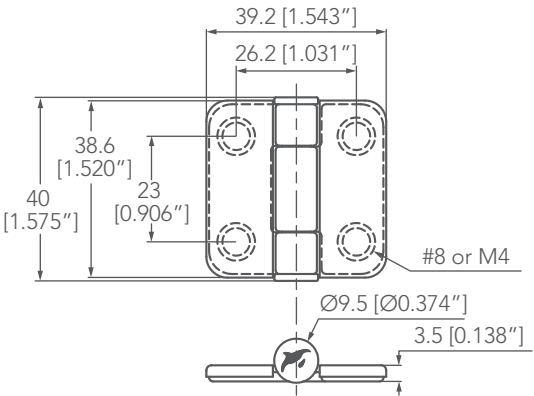

FRICITION HINGE

Stainless Steel 316

- Provides constant torque throughout the entire range of motion.
- Holds door open at any desired angle without torque adjustment.
- Ideal for light-weight doors, such as overhead door, baitwell lid, glove box, interior door, anchor locker, electronic panel, etc.
- Passed 10,000 times cycle test and lost less than 10% on torque; 20,000 times lost only 20% or less.
- Passed 500-hour salt-spray test.



0319221-A-B

Bulk No.	Screw	Type	Size
0319221-A 0319221	#8 M4	Barrel Up	37mm X 38mm 1-7/16" X 1-1/2" Torque Range: 1.5±0.4N-m
0319221-AH 0319221-H	#8 M4	Barrel Up	37mm X 38mm 1-7/16" X 1-1/2" Torque Range: 1.73±0.23N-m

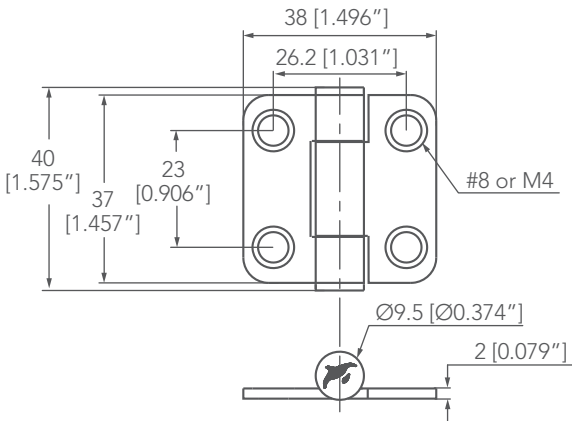

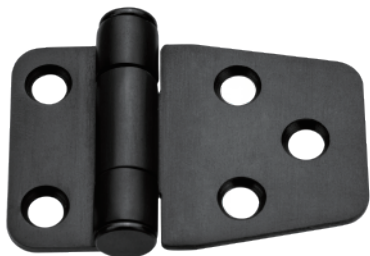

0319227-A-B

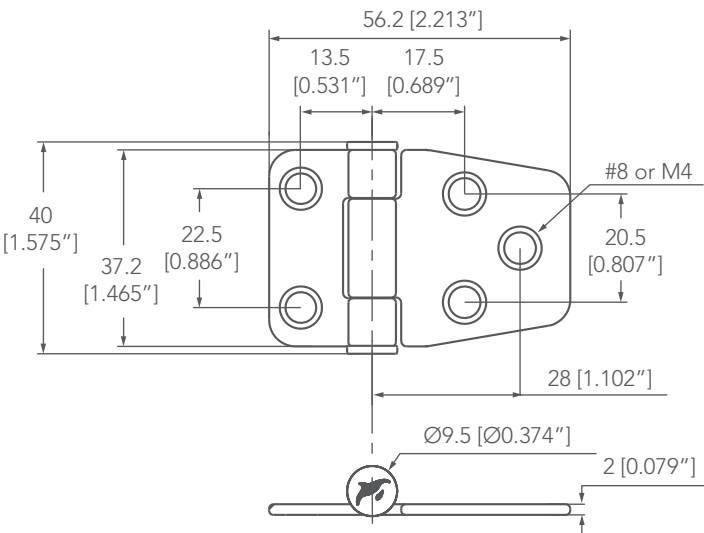

Bulk No.	Screw	Type	Size
0319227-A	#8	Barrel Up	37.2mm X 56.2mm
0319227	M4		1-7/16" X 2-3/16" Torque Range: 1.5±0.4N-m



0319223-A-B

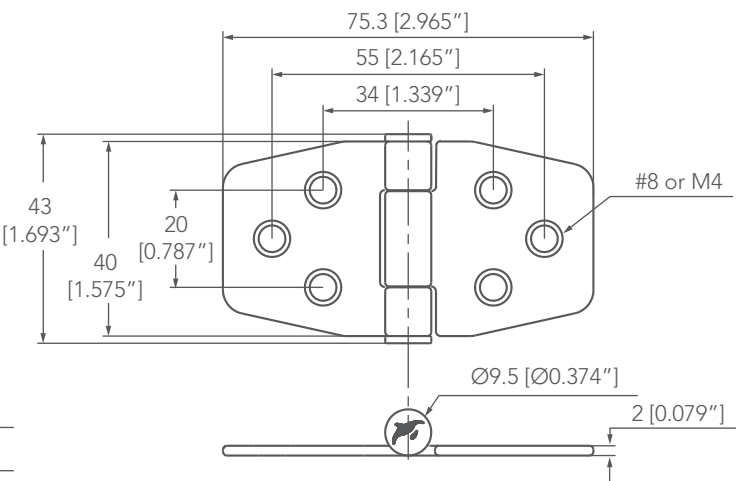

Bulk No.	Screw	Type	Size
0319223-A	#8	Barrel Up	40mm X 75.3mm
0319223	M4		1-9/16" X 2-15/16" Torque Range: 1.6±0.4N-m

BUTTERFLY HINGE

Stainless Steel 316

- Modern shape and simplified two seam barrel design.
- The unique covers are built into the pivot for permanent use and concealing the screws.
- Push cover to snap in place. Can be unsnapped by using a small flat-head screwdriver.
- Fits different countersunk screw types.
- Silicone caulking on cover is required for specific application use.
- Passes 500 hours salt-spray test.
- If this hinge is mounted in the pocket, make sure to have enough room around the hinge leaves to allow the covers to be snapped down.
- Glossy black finish is not available.



INSTRUCTION

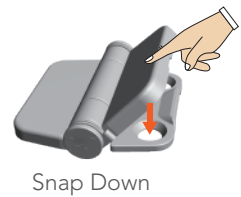
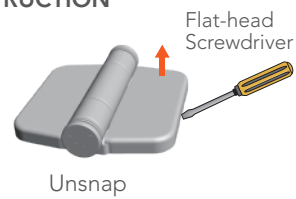



0219311-B

Bulk No.	Type	Size
0219311	Barrel Up	39.6mm X 41.8mm 1-9/16" X 1-5/8" Screw : #8 or M4.

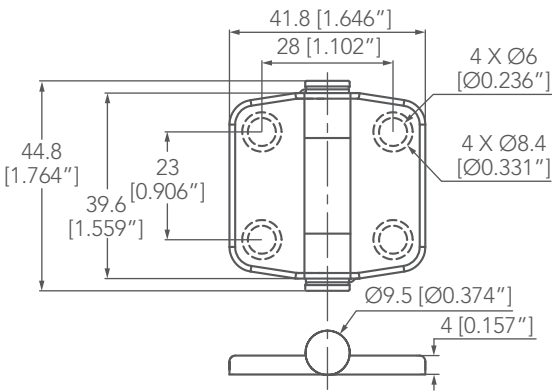

0319313-B

Bulk No.	Type	Size
0319313	Barrel Up	39.6mm X 78mm 1-9/16" X 3-1/16" Screw : #8 or M4.

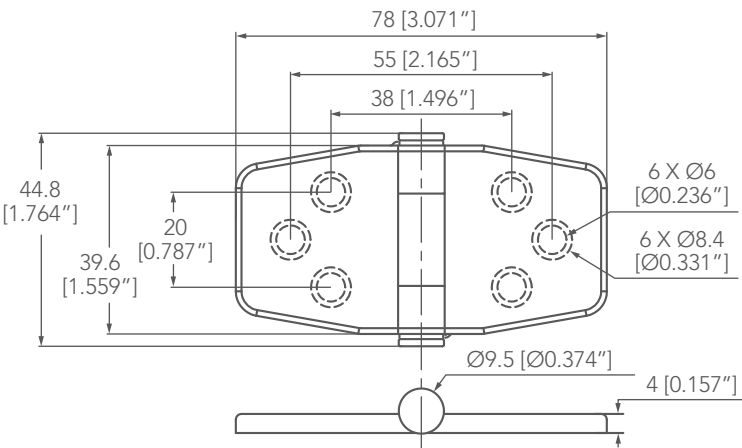

0319413-B

Bulk No.	Type	Size
0319413	Center Barrel	39.6mm X 78mm 1-9/16" X 3-1/16" Screw : #8 or M4.

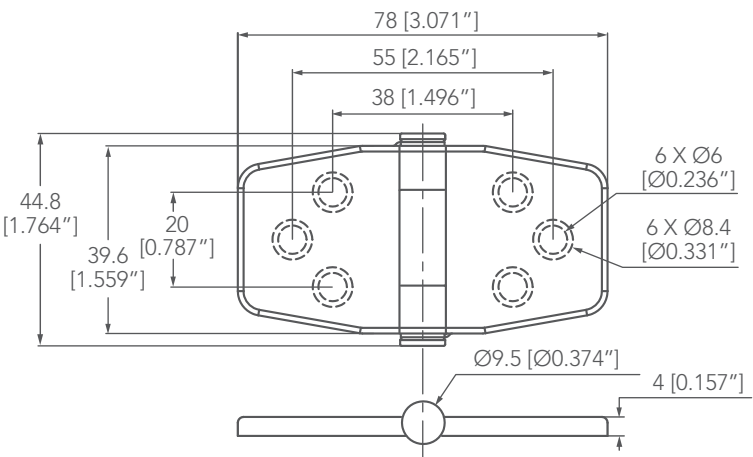



0319317-B

Bulk No.	Type	Size
0319317	Barrel Up	39.6mm X 59.9mm 1-9/16" X 2-3/8" Screw : #8 or M4.

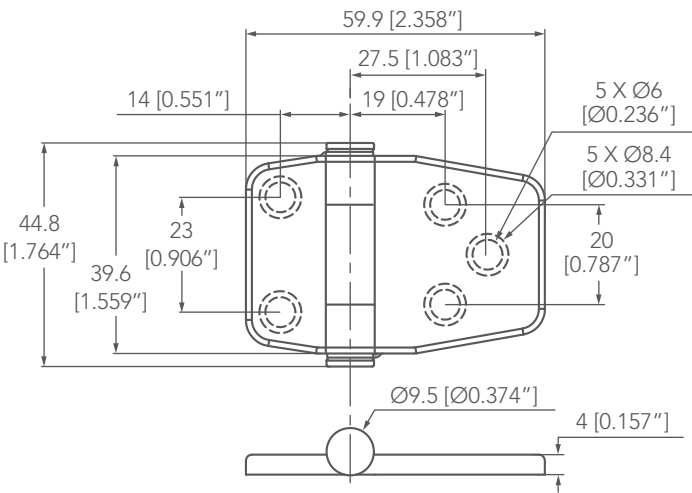

0319319-B

Bulk No.	Type	Size
0319319	Barrel Up	66.2mm X 66.6mm 2-5/8" X 2-5/8" Screw : #10 or M5.

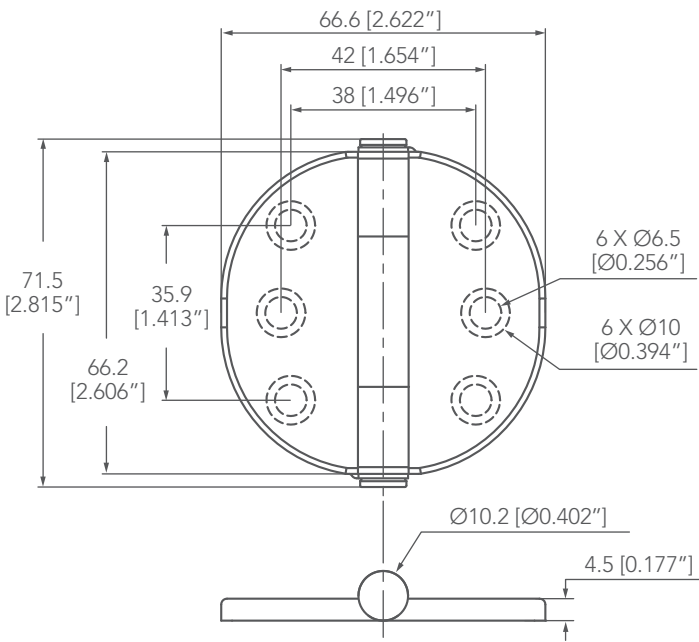



0319315-B

Bulk No.	Type	Size
0319315	Barrel Up	78mm X 78mm 3-1/16" X 3-1/16" Screw : #10 or M5.

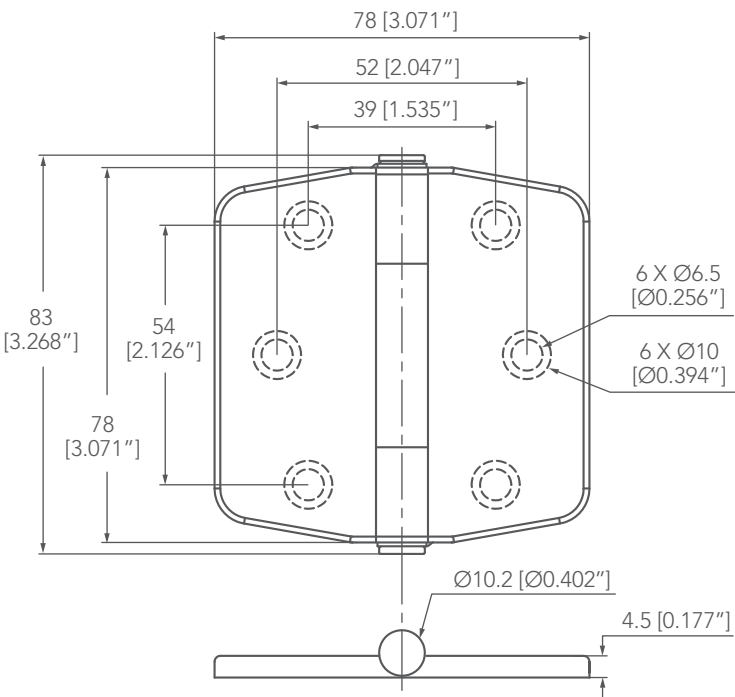

0319415-B

Bulk No.	Type	Size
0319415	Center Barrel	78mm X 78mm 3-1/16" X 3-1/16" Screw : #10 or M5.

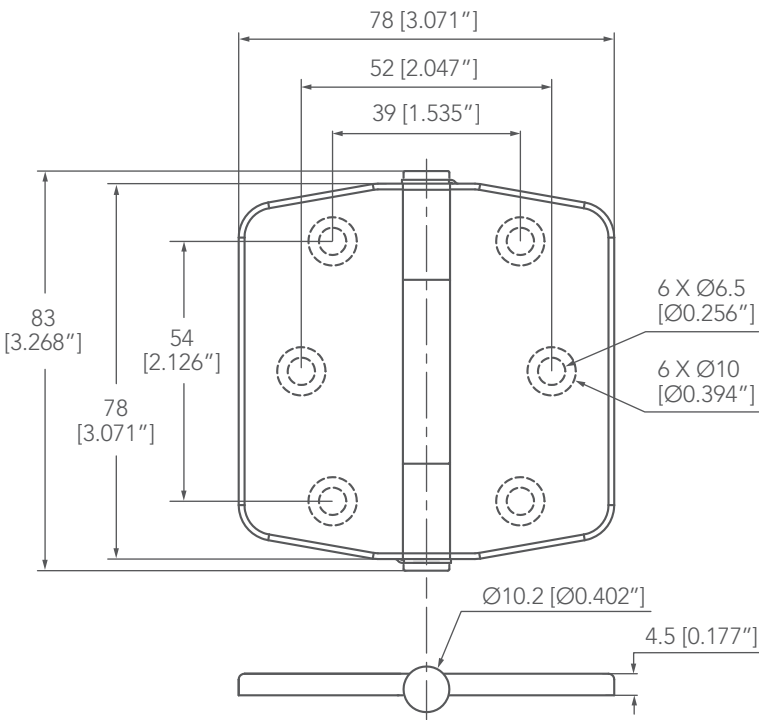

CAST HINGE

Stainless Steel 316

- Low profile design.
- Barrel is welded closed on both ends.
- Tight tolerance construction.
- Durability and beauty combined.



8631409-B

Bulk No.	Type	Size
8631409	Barrel Down	42mm X 70.5mm 1-5/8" X 2-3/4" Screw : #8 or M4.

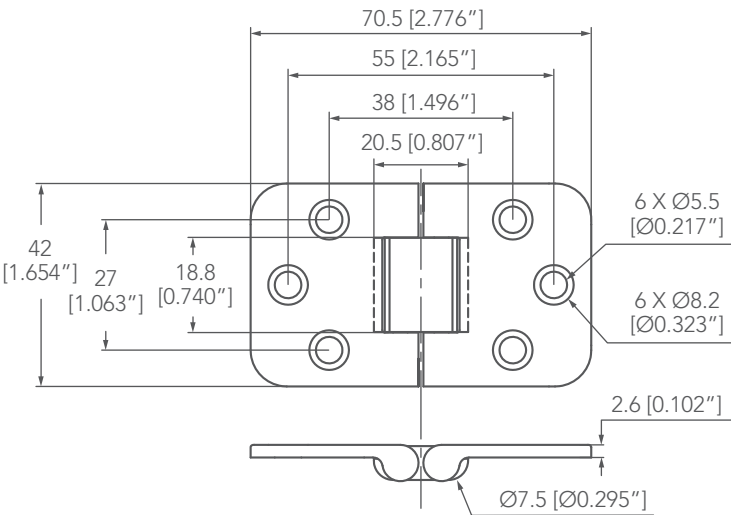



Technical drawing of a mechanical part, showing a side view and a cross-sectional view. The side view dimensions are:

- Overall width: 37 [1.457"]
- Distance between mounting holes: 24 [0.945"]
- Overall height: 37.5 [1.476"]
- Distance from top edge to mounting holes: 25 [0.984"]
- Mounting holes: 4 X Ø4.5 [Ø0.177"]
- Internal holes: 4 X Ø8 [Ø0.315"]

The cross-sectional view shows a base with a central hole of diameter Ø7 [Ø0.276"] and a flange with a thickness of 3 [0.118"].



Technical drawing of a mechanical part, likely a bracket or flange, showing top and side views with dimensions in millimeters and inches.

Top View Dimensions:

- Overall width: 76.5 [3.012"]
- Distance from centerline to outer edge: 61 [2.402"]
- Distance from centerline to mounting hole center: 25 [0.984"]
- Overall height: 37.5 [1.476"]
- Distance from top edge to mounting hole center: 22 [0.866"]

Mounting Holes:

- 6 X Ø4.5 [Ø0.177"]
- 6 X Ø8.2 [Ø0.323"]

Side View Dimensions:

- Radius of the semi-circular feature: Ø7.6 [Ø0.299"]
- Height of the side flange: 3.5 [0.138"]



Technical drawing of a mechanical part, showing a top view and a side view.

Top View Dimensions:

- Overall width: 75 [2.953"]
- Overall height: 37 [1.457"]
- Inner width (excluding slot): 60 [2.362"]
- Inner height (excluding slot): 37 [1.457"]
- Slot width: 20 [0.787"]
- Slot depth: 3.2 [0.126"]
- Distance from top edge to center of top holes: 20 [0.787"]
- Distance from bottom edge to center of bottom holes: 20 [0.787"]

Side View Dimensions:

- Overall thickness: 3.2 [0.126"]
- Central protrusion diameter: Ø7 [Ø0.276"]

Feature Callouts:

- 6 X Ø4.5 [Ø0.177"] (Six small holes, three on each side)
- 6 X Ø8.2 [Ø0.323"] (Six larger holes, three on each side)



8936631-B

Bulk No.	Type	Size
8936631	Barrel Up	38mm X 60mm 1-1/2" X 2-3/8" Screw : #8 or M4.

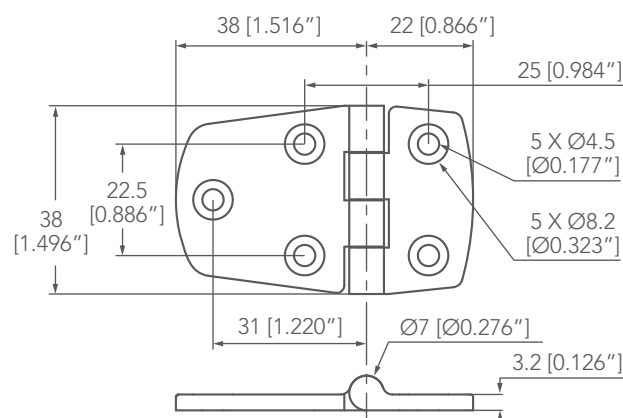

8936632-B

Bulk No.	Type	Size
8936632	Barrel Up	38mm X 74mm 1-1/2" X 2-15/16" Screw : #8 or M4.

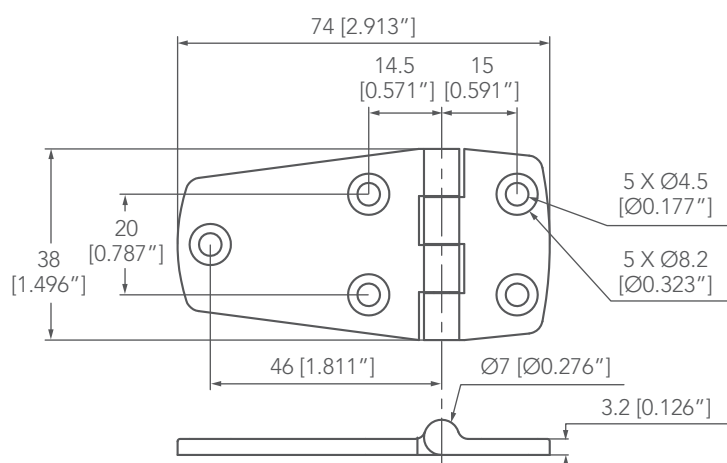

9519380-B

Bulk No.	Type	Size
9519380	Barrel Up	38mm X 60mm 1-1/2" X 2-3/8" Screw : #8 or M4.

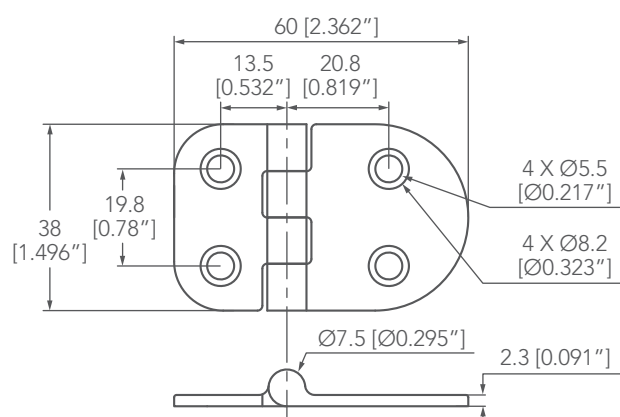



9324320-B

Bulk No.	Type	Size
9324320	Barrel Down	38mm X 60mm 1-1/2" X 2-3/8" Screw : #8 or M4.

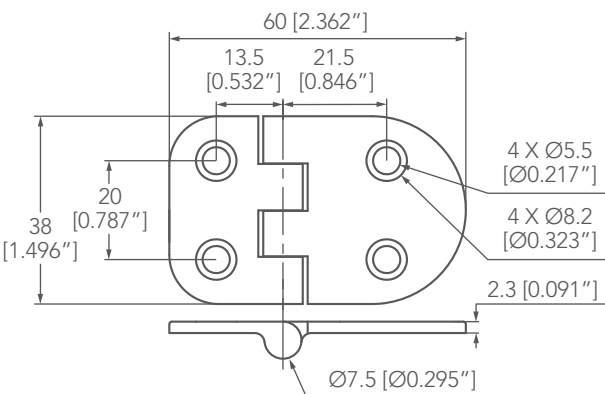

8936645-B

Bulk No.	Type	Size
8936645	Barrel Up	38.6mm X 75mm 1-1/2" X 2-15/16" Screw : #8 or M4.

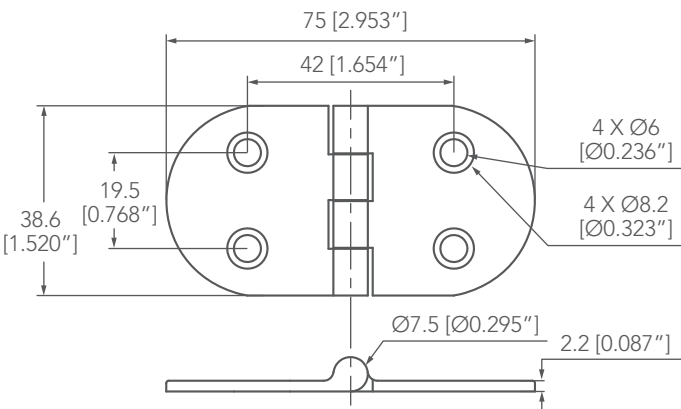

8936606-B

Bulk No.	Type	Size
8936606	Barrel Down	38.6mm X 75mm 1-1/2" X 2-15/16" Screw : #8 or M4.

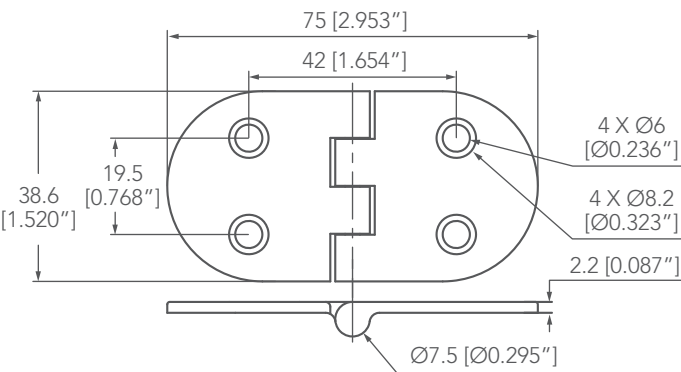



9122250-B

Bulk No.	Type	Size
9122250	Barrel Up	76.5mm X 50mm 3" X 2" Screw : #10 or M5.

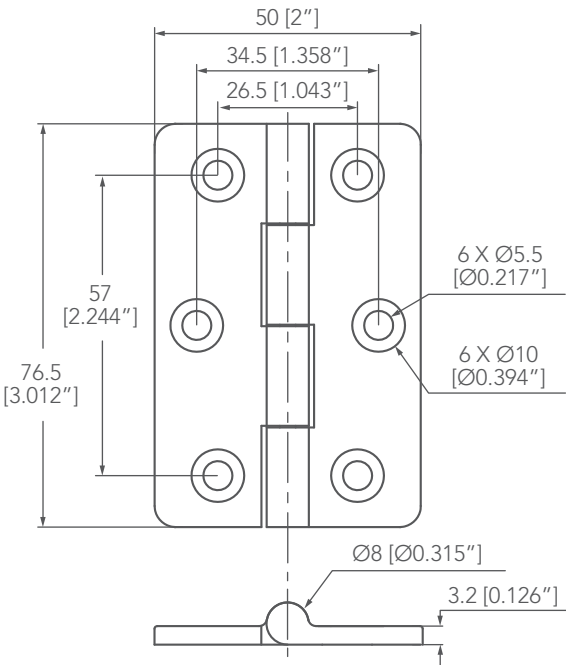

9519876-B

Bulk No.	Type	Size
9519876	Barrel Up	77mm X 51mm 3" X 2" Screw : #10 or M5.

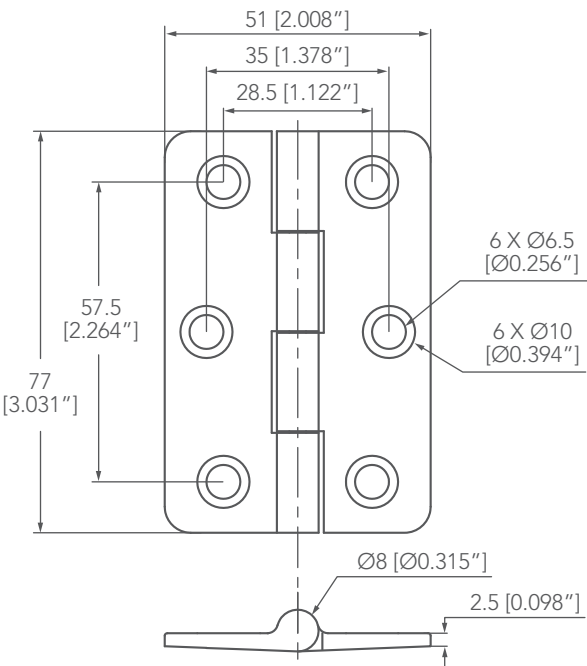



9120660-B

Bulk No.	Type	Size
9120660	Barrel Up	77mm X 76.2mm 3" X 3" Screw : #10 or M5.

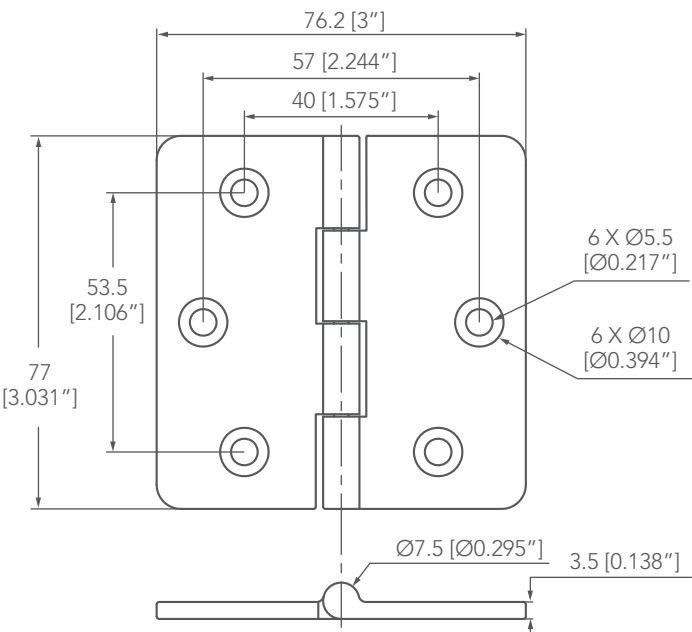

8936613-B

Bulk No.	Type	Size
8936613	Barrel Up	101mm X 82mm 4" X 3-1/4" Screw : M6.

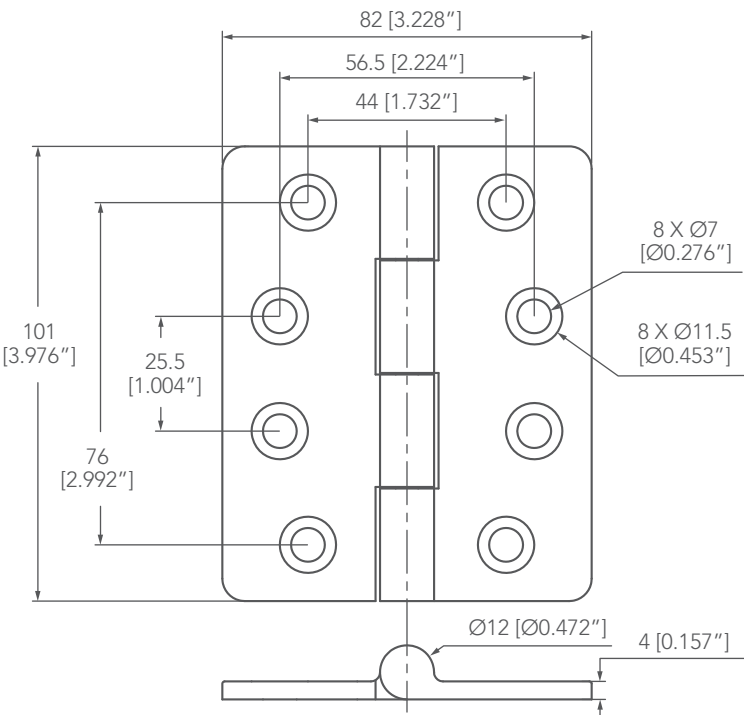



0319292-B

Bulk No.	Type	Size
0319292	Barrel Up	76.2mm X 98.4mm 3" X 3-7/8" Screw : #10 or M5.

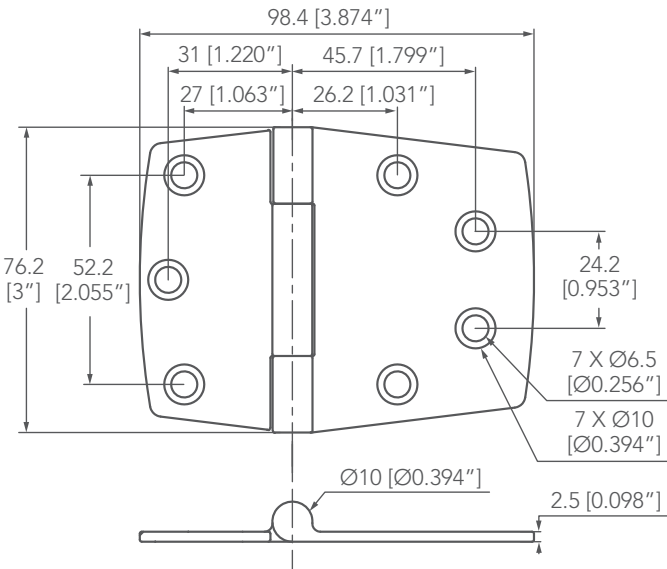

WE PRODUCE BOAT JEWELRY

MARINE TOWN INC. (TAIWAN)

18F-1, No.33, Sec. 1, Minsheng Rd.,
Bangqiao Dist., New Taipei City 220, Taiwan
E info@marinetown.com.tw
T 886 2 2957 9880
F 886 2 2957 9882

MARINE TOWN INC. (USA)

2061 NW US Highway 19,
Crystal River, FL 34428, USA
E info@marinetown.com
T 352-564-1150
F 352-564-1156



since 1988